

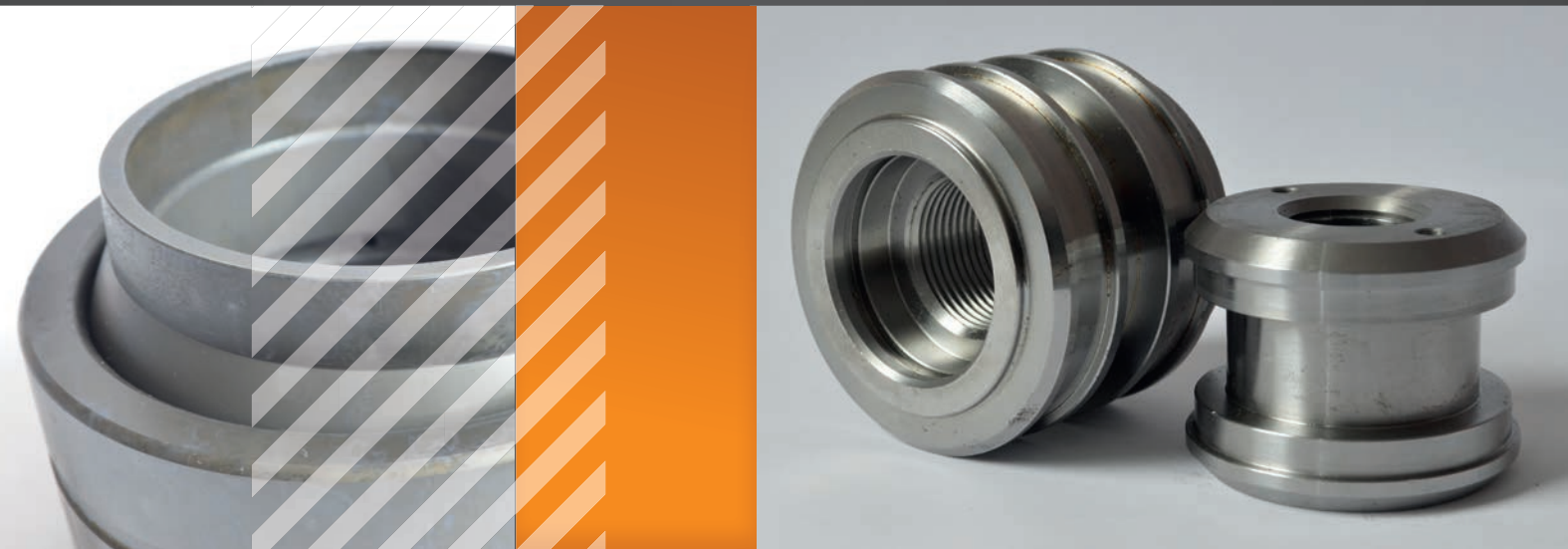

ZYLINDER UND KOMPONENTEN



INHALT



PRODUKTÜBERSICHT	04-05	BEFESTIGUNGEN	59-73
TECHNISCHE ANGABEN	06-07	CFL, CPB, CB, CBF, CAGE, CAGEG, CAGEN, COF, CFS, CFF, CFP, GEDO/GEDO2RS, GE LO, GEFO/GEFO2RS, GE HO2RS, GEUK/GEUK2RS, CSTS...C, CSTS...N, CSTSCE...N, CSTAPR...CE, CSTAPR...U, CSTAPR...N, CSTFE...DO, CSTFI...DO, CSB, CSBOO, CSR, ADU/AKX, CBAGF	
DOPPELWIRKENDE ZYLINDER HMO/HMOLM, HMF, HFR2S, HM1, HM2, HM5, HMB, HMC	08-22	KOMPONENTEN FÜR GEDÄMFTEN ZYLINDER	74
PLUNGERZYLINDER HTO, HFRT	24-25	CBDF, CFD	
SONDERZYLINDER IP, IH, IM, IC	26-31	ZYLINDERKOMPONENTEN IN ZOLL	75-77
GEDREHTE ZYLINDERROHRE UND KOLBENSTANGEN STL/STS, STFG, SBL, SBFG	32-39	CGIN, CTIN, CFIN, CFIP, CBSJ, CBSNPT, CDAIN/CDBIN	
KOLBENSTANGENFÜHRUNGEN CG, CG30, CGLM, CGPM, CGT, CGHFRT	40-43	ZYLINDERKOMPONENTEN AUS ROSTFREIEM STAHL AISI316	78-80
KOLBEN CT, CT30, CTLM, CTPM, CTF, CTBF, CTFG, CTT	44-47	CGXX, CFX, CBSX, CFEX, CBX, COFX, CFFX, CAGEX, GE TGR	
BÖDEN CF, CFC, CF30, CFPM, CFI, CFO, CFHR, CHFRT, CFVP, CFE, CFB, CSTSNF	48-53	ROHSTOFFE	81-84
ZUBEHÖRE CBS, CBSP, CBSL, CBSLT, CBL, CDIS, CDA/CDB, CAT, CA, ASEP, ATS, APG/APM, APSEP	54-58	FT/FTL, FAC, FACV/FACM/FAX, FTLX, FTE, FGP	
		HYDRAULIKVENTILE UND ZUBEHÖR	85-89
		VRSE-F...FF, VRDE-F...FF, VRSE-AZ...FF, VRDE-AZ...FF, VBCD/A SE, VBCD/A DE, VUBA, VCG391/VCG392, RV535, RV431, RD081, RD088, DR092, GAB	
		DICHTSÄTZE	90
		GKG	

DOPPELWIRKENDE ZYLINDER



PLUNGERZYLINDER

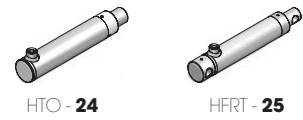

SONDERZYLINDER

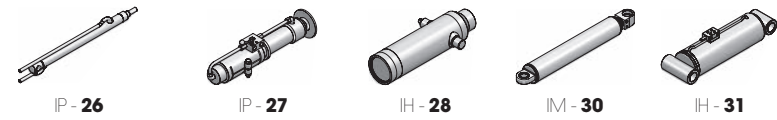

GEDREHTE ZYLINDERROHRE UND KOLBENSTANGEN

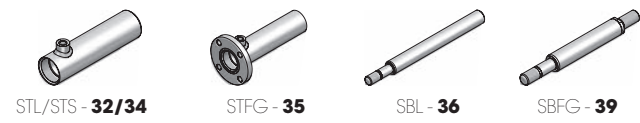

KOLBENSTANGENFÜHRUNGEN



KOLBEN



BÖDEN

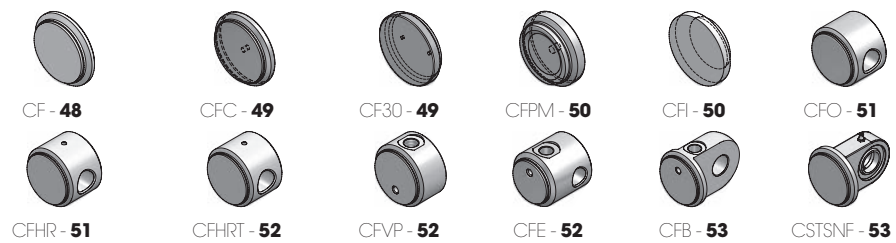

ZUBEHÖRE

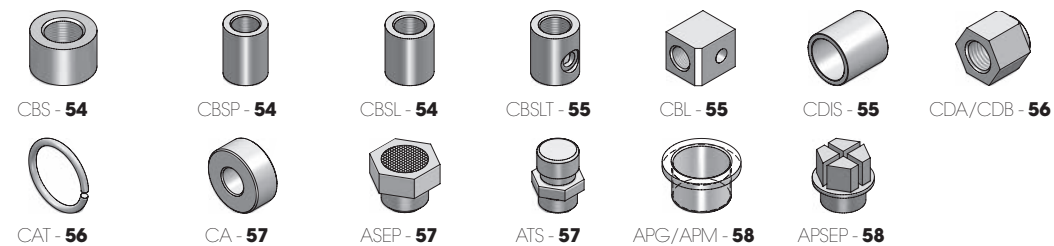

KOMPONENTEN FÜR GEDÄMPFTE ZYLINDER



BEFESTIGUNGEN

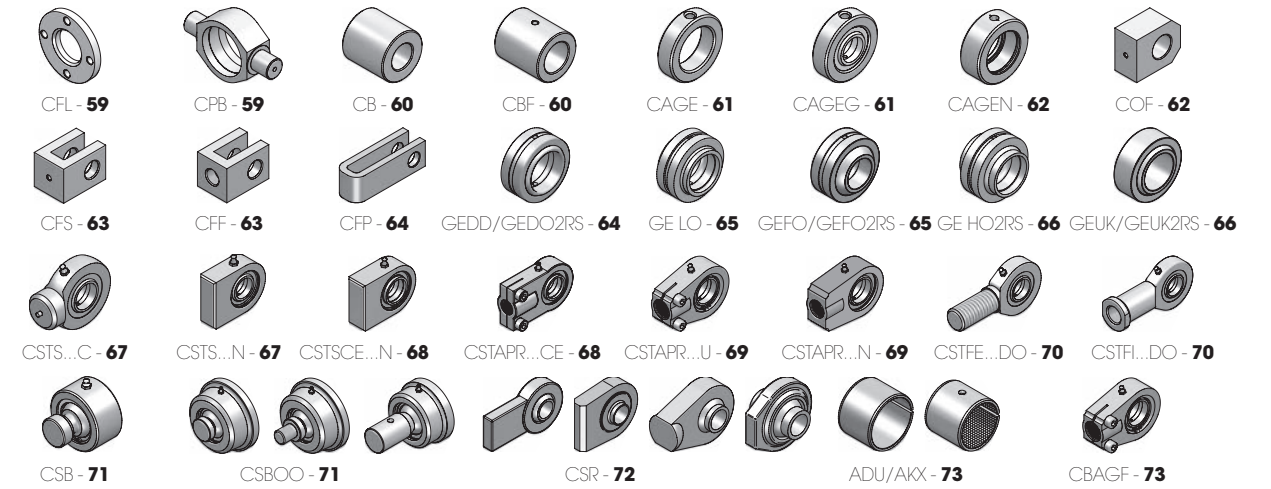

ZYLINDERKOMPONENTEN IN ZOLL

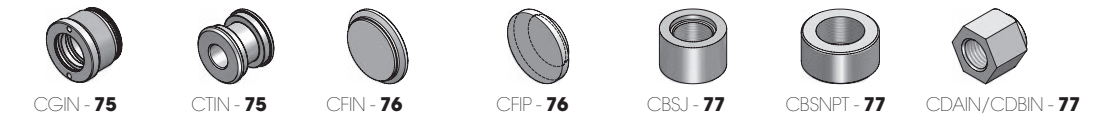

ZYLINDERKOMPONENTEN AUS ROSTFREIEM STAHL AISI 316

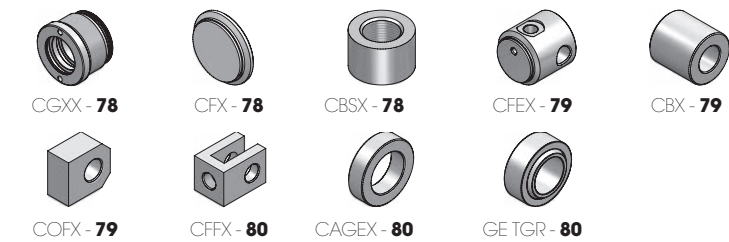

ROHSTOFFE



HYDRAULIKVENTILE UND ZUBEHÖR

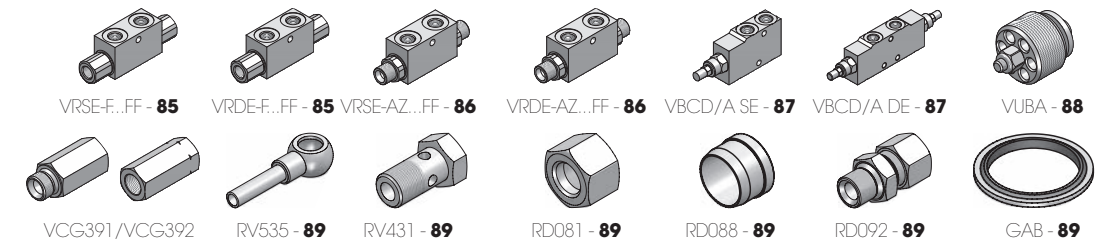

DICHTSÄTZE



TYPE „HMO“ - „HMOLM“

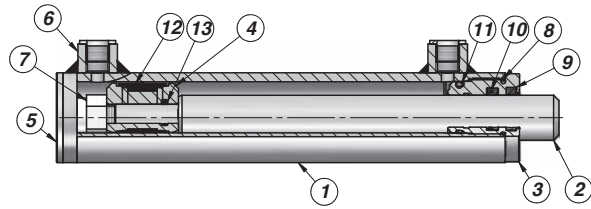

„HMO“ Max. Pressure - Max. Druck: 210 Bar
 „HMOLM“ Max. Pressure - Max. Druck: 180 Bar

TYPE „HFR2S“

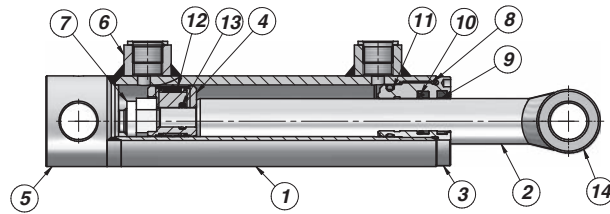

„HFR2S“ Max. Pressure - Max. Druck: 210 Bar

TYPE „HMF“

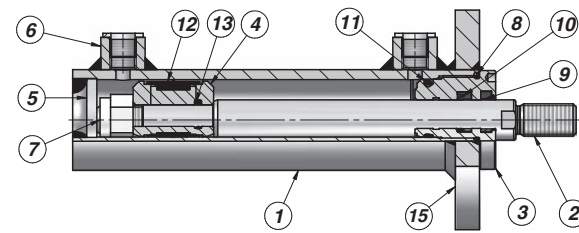

„HMF“ Max. Pressure - Max. Druck: 210 Bar

TYPE „HTO“

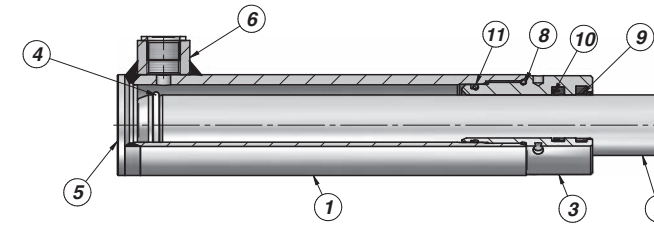

„HTO“ Max. Pressure - Max. Druck: 210 Bar

TYPE „HFRT“

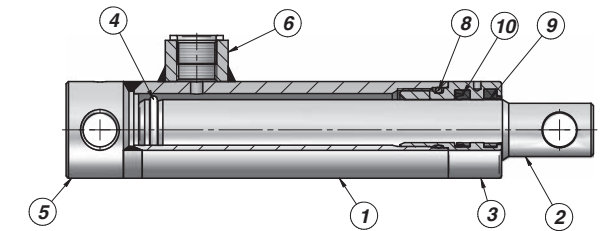

„HFRT“ Max. Pressure - Max. Druck: 210 Bar

1	POLISHED TUBE - POLIERTES ZYLINDERROHR	STEEL - STAHL: St 52.3 DIN 2393 ISO H9
2	CHROMED ROD - VERCHROMTE KOLBENSTANGE	STEEL - STAHL: UNI C45 - SAE 1045 CHROME - CHROM: 25 MICRON +-5
3	HEAD-BUSH - KOLBENSTANGENFÜHRUNG	HYDRAULIC CAST IRON - HYDRAULICGUSS: UNI 5007-G25
4	PISTON - KOLBEN	STEEL - STAHL: 9SMn28
5	END-PLUG - ZYLINDERBODEN	STEEL - STAHL: S355J0 (Fe510C) - S355JR (A105)
6	THREADED PORT - ANSCHLUSSGEWINDE	STEEL - STAHL: 9SMn28
7	LOCKNUT - SELBSTSPERRENDE MUTTER	STEEL - STAHL: UNI 7473 - 7474
8	SEAL - DICHTUNG O-RING	NBR 70 SHORE
9	SEAL - DICHTUNG „GHK“	POLYURETHANE - POLYURETHAN
10	SEAL - DICHTUNG „TSE-TTS-TTI/L“	„TSE“: NBR+FABRIC - NBR+GEWEBE „TTS-TTI/L“: POLYURETHANE - POLYURETHAN
11	SEAL - DICHTUNG O-RING	NBR 70 SHORE
12	SEAL - DICHTUNG „TPM“	NBR+POM+POLYESTER
13	SEAL - DICHTUNG O-RING	NBR 70 SHORE
14	BUSH - BUCHSE	STEEL - STAHL: S355J0 (Fe510C)
15	FLANGE - FLANSCH	STEEL - STAHL: S355J0 (Fe510C)

Top Speed - Höchstgeschwindigkeit: max 0,5 m/s
 Temperature C° - Temperaturbereich C°: -25°C - +80 °C

1	POLISHED TUBE - POLIERTES ZYLINDERROHR	STEEL - STAHL: St 52.3 DIN 2393 ISO H9
2	CHROMED ROD - VERCHROMTE KOLBENSTANGE	STEEL - STAHL: UNI C45 - SAE 1045 CHROME - CHROM: 25 MICRON +-5
3	HEAD-BUSH - KOLBENSTANGENFÜHRUNG TYPE - TYP: „HTO“	HYDRAULIC CAST IRON - HYDRAULICGUSS: UNI 5007-G25
3	HEAD-BUSH - KOLBENSTANGENFÜHRUNG TYPE - TYP: „HFRT“	STEEL: 9SMn28 WITH „NI-TEMPER“ TREATMENT STAHL: 9SMn28 MIT „NI-TEMPER-BEHANDLUNG“
4	STOP RING - KLEMMRING	STEEL - STAHL
5	END-PLUG - ZYLINDERBODEN	STEEL - STAHL: S355J0 (Fe510C) - S355JR (A105)
6	THREADED PORT - ANSCHLUSSGEWINDE	STEEL - STAHL: 9SMn28
8	SEAL - DICHTUNG TYPE - TYP: „HTO“ O-RING	NBR 70 SHORE
8	SEAL - DICHTUNG TYPE - TYP: „HFRT“ O-RING	NBR 70 SHORE
9	SEAL - DICHTUNG „GHK“	POLYURETHANE - POLYURETHAN
10	SEAL - DICHTUNG „TSE-TTS-TTI/L“	„TSE“: NBR+FABRIC - NBR+GEWEBE „TTS-TTI/L“: POLYURETHANE - POLYURETHAN
11	SEAL - DICHTUNG O-RING	NBR 70 SHORE

Top Speed - Höchstgeschwindigkeit: max 0,5 m/s
 Temperature C° - Temperaturbereich C°: -25°C - +80 °C

HMO | M250

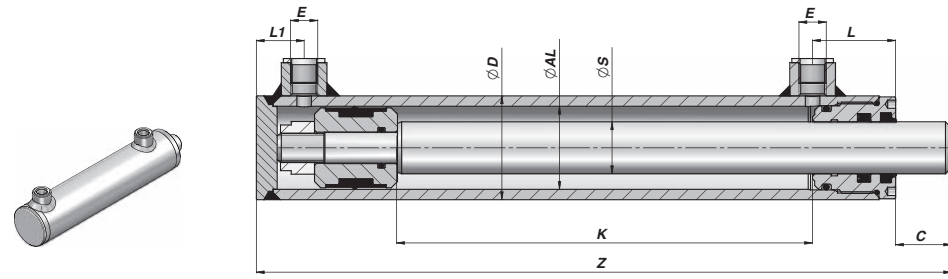

Code Bestell-Nr.	K	Z	kg	E BSP	L	L1	C	Code Bestell-Nr.	K	Z	kg
ØD 35 ØAL 25 ØS 16											
HM0025160050	50	135	0,75	1/4"	33	15	17				
HM0025160100	100	185	0,95								
HM0025160150	150	235	1,25								
HM0025160200	200	285	1,50								
ØD 42 ØAL 32 ØS 20											
HM0032200050	50	155	1,30	1/4"	33	20	16				
HM0032200100	100	205	1,60								
HM0032200150	150	255	1,95								
HM0032200200	200	305	2,30								
HM0032200250	250	355	2,70								
HM0032200300	300	405	3,00								
HM0032200400	400	505	3,70								
HM0032200500	500	605	4,40								
ØD 50 ØAL 40 ØS 25											
HM01200100	100	230	2,27	1/4"	40	23	22	HM01250100	100	230	2,50
HM01200150	150	280	2,67					HM01250150	150	280	2,95
HM01200200	200	330	3,05					HM01250200	200	330	3,39
HM01200250	250	380	3,45					HM01250250	250	380	3,85
HM01200300	300	430	3,85					HM01250300	300	430	4,32
HM01200350	350	480	4,27					HM01250350	350	480	4,79
HM01200400	400	530	4,65					HM01250400	400	530	5,26
HM01200450	450	580	5,08					HM01250450	450	580	5,72
HM01200500	500	630	5,49					HM01250500	500	630	6,20
								HM01250550	550	680	6,60
				HM01250600	600	730	7,13				
ØD 60 ØAL 50 ØS 25											
HM02250100	100	240	3,29	3/8"	43	26	22	ØD 60 ØAL 50 ØS 30			
HM02250150	150	290	3,83					HM02300150	150	290	4,11
HM02250200	200	340	4,34					HM02300200	200	340	4,74
HM02250250	250	390	4,85					HM02300250	250	390	5,35
HM02250300	300	440	5,35					HM02300300	300	440	5,97
HM02250350	350	490	5,94					HM02300350	350	490	6,55
HM02250400	400	540	6,40					HM02300400	400	540	7,20
HM02250450	450	590	7,30					HM02300450	450	590	7,80
HM02250500	500	640	7,43					HM02300500	500	640	8,42
HM02250550	550	690	8,06					HM02300550	550	690	9,04
HM02250600	600	740	8,46					HM02300600	600	740	9,64
								HM02300700	700	840	10,85
HM02250800	800	940	10,71					HM02300800	800	940	12,10
HM02251000	1000	1140	12,87					HM02301000	1000	1140	14,57
ØD 70 ØAL 60 ØS 30											
HM03300100	100	260	4,82	3/8"	50	30	23	ØD 70 ØAL 60 ØS 35			
HM03300150	150	310	5,55					HM03350100	100	260	5,07
HM03300200	200	360	6,20					HM03350150	150	310	5,85
HM03300250	250	410	6,87					HM03350200	200	360	6,60
HM03300300	300	460	7,55					HM03350250	250	410	7,40
HM03300350	350	510	8,20					HM03350300	300	460	8,15
HM03300400	400	560	8,90					HM03350350	350	510	8,94
HM03300450	450	610	9,53					HM03350400	400	560	9,72
HM03300500	500	660	10,25					HM03350450	450	610	10,47
HM03300550	550	710	10,86					HM03350500	500	660	11,25
HM03300600	600	760	11,60					HM03350550	550	710	12,00
HM03300800	800	960	14,26					HM03350600	600	760	12,81
HM033001000	1000	1160	17,00					HM03350800	800	960	15,87
								HM033501000	1000	1160	18,93

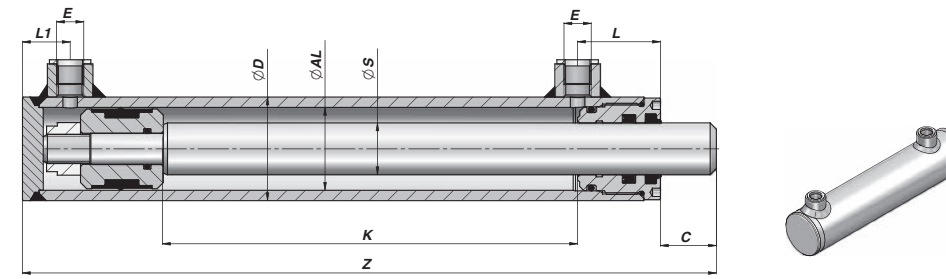

Code Bestell-Nr.	K	Z	kg	E BSP	L	L1	C	Code Bestell-Nr.	K	Z	kg
ØD 70 ØAL 60 ØS 40											
HM03400200	200	360	7,25	3/8"	50	30	23	ØD 73 ØAL 63 ØS 40			
HM03400250	250	410	8,14					HM0063400200	200	360	7,60
HM03400300	300	460	9,03					HM0063400250	250	410	8,50
HM03400350	350	510	9,90					HM0063400300	300	460	9,40
HM03400400	400	560	10,79					HM0063400350	350	510	10,30
HM03400450	450	610	11,64					HM0063400400	400	560	11,20
HM03400500	500	660	12,52					HM0063400450	450	610	12,10
HM03400550	550	710	13,45					HM0063400500	500	660	13,00
HM03400600	600	760	14,30					HM0063400550	550	710	13,90
HM03400800	800	960	17,82					HM0063400600	600	760	14,80
HM03401000	1000	1160	21,40	HM0063400800	800	960	18,50				
				HM0063401000	1000	1160	22,10				
ØD 80 ØAL 70 ØS 35											
HM04350100	100	260	6,09	3/8"	50	33	23	ØD 80 ØAL 70 ØS 40			
HM04350150	150	310	6,95								
HM04350200	200	360	7,74					HM04400200	200	360	8,28
HM04350250	250	410	8,60					HM04400250	250	410	9,26
HM04350300	300	460	9,40					HM04400300	300	460	10,24
HM04350350	350	510	10,26					HM04400350	350	510	11,20
HM04350400	400	560	11,00					HM04400400	400	560	12,80
HM04350450	450	610	11,88					HM04400450	450	610	13,11
HM04350500	500	660	12,60					HM04400500	500	660	14,01
HM04350550	550	710	13,66					HM04400550	550	710	15,10
HM04350600	600	760	14,20	HM04400600	600	760	15,99				
HM04350800	800	960	17,56	HM04400800	800	960	19,73				
HM04351000	1000	1160	21,26	HM04401000	1000	1160	23,51				
ØD 92 ØAL 80 ØS 40											
HM05400200	200	380	11,08	1/2"	60	35	25	ØD 92 ØAL 80 ØS 50			
HM05400250	250	430	12,22					HM05500200	200	380	12,35
HM05400300	300	480	13,35					HM05500250	250	430	13,73
HM05400400	400	580	15,56					HM05500300	300	480	15,15
HM05400500	500	680	17,77					HM05500400	400	580	17,95
HM05400600	600	780	19,98					HM05500500	500	680	20,71
HM05400800	800	980	24,50					HM05500600	600	780	24,00
HM05401000	1000	1180	28,92					HM05500800	800	980	29,50
				HM05501000	1000	1180	35,00				
ØD 105 ØAL 90 ØS 50											
HM0090500300	300	486	19,30	1/2"	60	40	23	ØD 70 ØAL 60 ØS 35			
HM0090500400	400	586	22,64								
HM0090500500	500	686	25,97								
HM0090500600	600	786	29,0								
HM0090500800	800	986	35,97								
HM0090501000	1000	1186	42,64								
ØD 115 ØAL 100 ØS 50											
HM06500200	200	410	19,50	1/2"	82	38	25	ØD 115 ØAL 100 ØS 60			
HM06500250	250	460	21,50								
HM06500300	300	510	23,00					HM06600300	300	510	25,50
HM06500400	400	610	26,50					HM06600400	400	610	29,50
HM06500500	500	710	30,00					HM06600500	500	710	33,50
HM06500600	600	810	33,50					HM06600600	600	810	37,50
HM06500800	800	1010	40,50					HM06600800	800	1010	46,00
HM06501000	1000	1210	47,50					HM06601000	1000	1210	54,50

MATERIALE - MATERIAL:
 TUBE - ROHR: STEEL - STAHL St 52.3 DIN 2393 ISO H9
 ROD - KOLBENSTANGE: STEEL - STAHL UNI C45 SAE 1045 - CHROME - CHROM: 25 MICRON ±5

HMOLM | C200

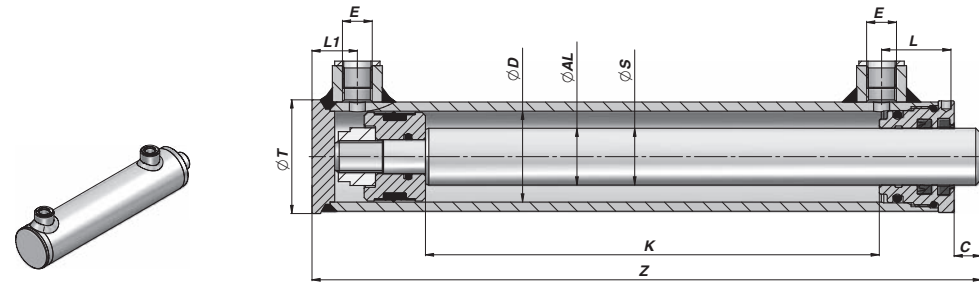

Code Bestell-Nr.	K	Z	kg	E BSP	L	L1	C	ØT	Code Bestell-Nr.	K	Z	kg
ØD 48 ØAL 40 ØS 20				ØD 48 ØAL 40 ØS 25								
HMOLM0400200100	100	195	1,73	1/4"	32	20	12	50	HMOLM0400250100	100	195	1,88
HMOLM0400200150	150	245	2,07						HMOLM0400250150	150	245	2,30
HMOLM0400200200	200	295	2,41						HMOLM0400250200	200	295	2,72
HMOLM0400200250	250	345	2,75						HMOLM0400250250	250	345	3,14
HMOLM0400200300	300	395	3,09						HMOLM0400250300	300	395	3,56
HMOLM0400200350	350	445	3,43						HMOLM0400250350	350	445	3,98
HMOLM0400200400	400	495	3,77						HMOLM0400250400	400	495	4,40
HMOLM0400200450	450	54	4,11						HMOLM0400250450	450	54	4,82
HMOLM0400200500	500	595	4,45						HMOLM0400250500	500	595	5,24
ØD 58 ØAL 50 ØS 25									ØD 58 ØAL 50 ØS 30			
HMOLM0500250100	100	205	2,58	3/8"	36	22	13	60	HMOLM0500300100	100	205	2,76
HMOLM0500250150	150	255	3,04						HMOLM0500300150	150	255	3,31
HMOLM0500250200	200	305	3,50						HMOLM0500300200	200	305	3,86
HMOLM0500250250	250	355	3,96						HMOLM0500300250	250	35	4,41
HMOLM0500250300	300	405	4,42						HMOLM0500300300	300	405	4,96
HMOLM0500250350	350	455	4,88						HMOLM0500300350	350	455	5,51
HMOLM0500250400	400	505	5,34						HMOLM0500300400	400	505	6,06
HMOLM0500250450	450	555	5,80						HMOLM0500300450	450	555	6,61
HMOLM0500250500	500	605	6,26						HMOLM0500300500	500	605	7,16
ØD 68 ØAL 60 ØS 30									ØD 68 ØAL 60 ØS 35			
HMOLM0600300100	100	220	3,76	3/8"	39	25	13	70	HMOLM0600350100	100	220	3,97
HMOLM0600300150	150	270	4,35						HMOLM0600350150	150	270	4,66
HMOLM0600300200	200	320	4,94						HMOLM0600350200	200	320	5,35
HMOLM0600300250	250	370	5,53						HMOLM0600350250	250	370	6,04
HMOLM0600300300	300	420	6,12						HMOLM0600350300	300	420	6,73
HMOLM0600300350	350	470	6,71						HMOLM0600350350	350	470	7,42
HMOLM0600300400	400	520	7,30						HMOLM0600350400	400	520	8,11
HMOLM0600300450	450	570	7,89						HMOLM0600350450	450	570	8,80
HMOLM0600300500	500	620	8,48						HMOLM0600350500	500	620	9,49
ØD 78 ØAL 70 ØS 35									ØD 78 ØAL 70 ØS 40			
HMOLM0700350100	100	220	4,81	3/8"	39	25	13	80				
HMOLM0700350150	150	270	5,55									
HMOLM0700350200	200	320	6,29						HMOLM0700400200	200	320	6,82
HMOLM0700350250	250	370	7,03						HMOLM0700400250	250	370	7,68
HMOLM0700350300	300	420	7,77						HMOLM0700400300	300	420	8,54
HMOLM0700350350	350	470	8,51						HMOLM0700400350	350	470	9,40
HMOLM0700350400	400	520	9,25						HMOLM0700400400	400	520	10,26
HMOLM0700350500	500	620	10,74						HMOLM0700400500	500	620	11,98

MATERIAL:
 TUBE - ROHR: STEEL - STAHL St 52.3 DIN 2393 ISO H9
 ROD - KOLBENSTANGE: STEEL - STAHL UNI C45 SAE 1045 - CHROME - CHROM: 25 MICRON ±5

HMF | M250

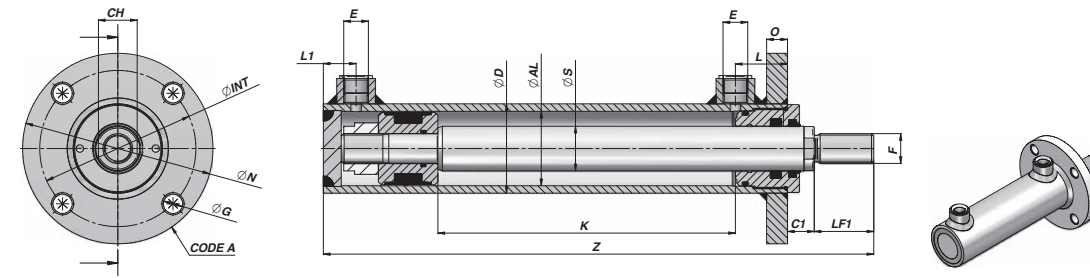

Code Bestell-Nr.	K	Z	kg	E BSP	L	L1	F	LF1	CH	C1	ØN	ØINT	ØG	Ø	Code A
ØD 50 ØAL 40 ØS 20				ØD 50 ØAL 40 ØS 20											
HMF1200	100	250	3,00	1/4"	32	25	M16x1,5	30	18	18	109	87	ø 11x14	12	CFL0050109
HMF1200	200	350	3,80												
HMF1200	300	450	4,60												
HMF1200	400	550	5,40												
HMF1200	500	650	6,20												
650 ØD 60 ØAL 50 ØS 30				650 ØD 60 ØAL 50 ØS 30											
HMF2300	100	270	4,60	3/8"	35	25	M20x1,5	40	26	18	128	105	ø 13x4	14	CFL0060128
HMF2300	200	370	5,80												
HMF2300	300	470	7,00												
HMF2300	400	570	8,0												
HMF2300	500	670	9,40												
ØD 70 ØAL 60 ØS 35				ØD 70 ØAL 60 ØS 35											
HMF3350	100	300	6,90	3/8"	40	30	M27x2	50	32	20	142	117	ø 13x4	16	CFL0070142
HMF3350	200	400	8,40												
HMF3350	300	500	9,90												
HMF3350	400	600	11,40												
HMF3350	500	700	12,90												
ØD 80 ØAL 70 ØS 40				ØD 80 ØAL 70 ØS 40											
HMF4400	100	312	8,63	3/8"	40	30	M30x2	60	36	22	162	127	ø 15x4	16	CFL0080162
HMF4400	200	412	10,53												
HMF4400	300	512	12,76												
HMF4400	400	612	15,00												
HMF4400	500	712	17,20												
ØD 95 ØAL 80 ØS 50				ØD 95 ØAL 80 ØS 50											
HMF5500	100	345	13,70	1/2"	50	40	M36x2	70	45	25	181	149	ø 17x6	18	CFL0095181
HMF5500	200	445	16,80												
HMF5500	300	545	19,90												
HMF5500	400	645	23,00												
HMF5500	500	745	26,10												
ØD 115 ØAL 100 ØS 50				ØD 115 ØAL 100 ØS 50											
HMF6500	100	375	20,20	1/2"	70	40	M36x2	70	45	27	194	162	ø 17x6	24	CFL0115194
HMF6500	200	475	25,80												
HMF6500	300	575	27,20												
HMF6500	400	675	30,80												
HMF6500	500	775	34,40												

MATERIAL:
 TUBE - ROHR: STEEL - STAHL St 52.3 DIN 2393 ISO H9
 ROD - KOLBENSTANGE: STEEL - STAHL UNI C45 SAE 1045 - CHROME - CHROM: 25 MICRON ±5

HFR2S | M250

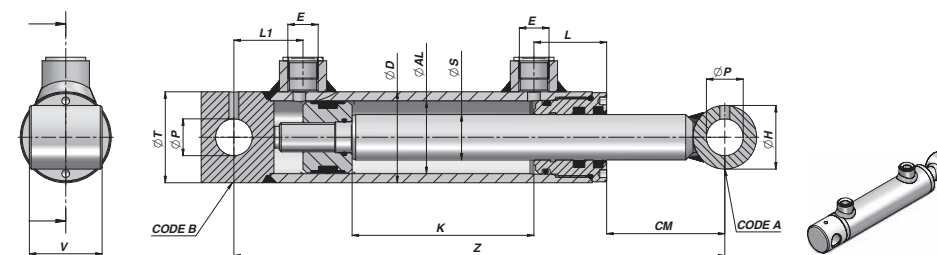
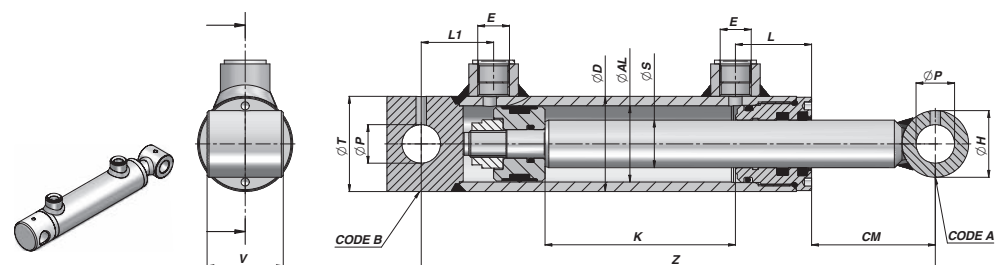

Code Bestell-Nr.	K	Z	kg	E BSP	L	L1	CM	ØP	ØH	V	ØT	Code A	Code B	Code Bestell-Nr.	K	Z	kg
ØD 35 ØAL 25 ØS 16				ØD 48 ØAL 40 ØS 25													
HFR016000	50	160	1,00	1/4"	33	22	31	12,1	25	25	35	CBF0012025025	CFHR035025				
HFR0160100	100	210	1,20														
HFR0160150	150	260	1,40														
HFR0160200	200	310	1,70														
ØD 42 ØAL 32 ØS 20				ØD 58 ØAL 50 ØS 30													
HFR0200050	50	205	1,70	1/4"	33	35	51	16,2	30	35	40	CBF0016030035	CFHR040032				
HFR0200100	100	255	2,10														
HFR0200150	150	305	2,40														
HFR0200200	200	355	2,80														
HFR0200250	250	405	3,10														
HFR0200300	300	455	3,50														
HFR0200400	400	555	4,20														
HFR0200500	500	655	4,80														
ØD 50 ØAL 40 ØS 25				ØD 68 ØAL 60 ØS 35													
HFR2S0400250100	100	270	3,00	3/8"	40	38	65	20,25	35	40	50	CBF1020035040	CFHR040020040				
HFR2S0400250150	150	320	3,40														
HFR2S0400250200	200	370	3,90														
HFR2S0400250250	250	420	4,40														
HFR2S0400250300	300	470	4,80														
HFR2S0400250400	400	570	5,80														
HFR2S0400250500	500	670	6,70														
HFR2S0400250600	600	770	7,60														
HFR2S0400250700	700	870	8,60														
HFR2S0400250800	800	970	9,50														
ØD 60 ØAL 50 ØS 30				ØD 78 ØAL 70 ØS 40													
HFR2S0500300100	100	300	4,40	3/8"	43	42	85	25,25	40	45	60	CBF1025040045	CFHR05002504				
HFR2S0500300150	150	350	5,00														
HFR2S0500300200	200	400	5,60														
HFR2S0500300250	250	450	6,20														
HFR2S0500300300	300	500	6,90														
HFR2S0500300400	400	600	8,10														
HFR2S0500300500	500	700	9,30														
HFR2S0500300600	600	800	10,0														
HFR2S0500300700	700	900	11,80														
HFR2S0500300800	800	1000	13,00														
HFR2S0500300900	900	1100	14,20														
HFR2S0500301000	1000	1200	15,50														

Code Bestell-Nr.	K	Z	kg	E BSP	L	L1	CM	ØP	ØH	V	ØT	Code A	Code B	Code Bestell-Nr.	K	Z	kg
ØD 70 ØAL 60 ØS 30				ØD 70 ØAL 60 ØS 35													
HFR2S0600300100	100	300	5,60	3/8"	50	36	83	25,25	40	45	70	CBF1025040045	CFHR060025047				
HFR2S0600300150	150	350	6,30														
HFR2S0600300200	200	400	7,00														
HFR2S0600300250	250	450	7,70														
HFR2S0600300300	300	500	8,30														
HFR2S0600300350	350	550	9,00														
HFR2S0600300400	400	600	9,70														
HFR2S0600300450	450	650	10,44														
HFR2S0600300500	500	700	11,00														
HFR2S0600300600	600	800	12,40														
HFR2S0600300700	700	900	13,70														
ØD 80 ØAL 70 ØS 40				ØD 70 ØAL 60 ØS 35													
HFR2S0700400200	200	410	10,10	3/8"	50	46	82	30,25	50	55	80	CBF1030050055	CFHR070030063				
HFR2S0700400250	250	460	11,00														
HFR2S0700400300	300	510	12,00														
HFR2S0700400350	350	560	13,00														
HFR2S0700400400	400	610	13,90														
HFR2S0700400450	450	660	14,90														
HFR2S0700400500	500	710	15,80														
HFR2S0700400600	600	810	17,70														
HFR2S0700400700	700	910	19,60														
HFR2S0700400800	800	1010	21,05														
HFR2S0700400900	900	1110	23,40														
ØD 92 ØAL 80 ØS 40				ØD 70 ØAL 60 ØS 35													
HFR2S0800400200	200	410	13,00	3/8"	60	42	70	30,25	50	55	90	CBF1030050055	CFHR080030060				
HFR2S0800400250	250	460	14,20														
HFR2S0800400300	300	510	15,30														
HFR2S0800400350	350	560	16,40														
HFR2S0800400400	400	610	17,50														
HFR2S0800400500	500	710	19,80														
HFR2S0800400600	600	810	22,00														
HFR2S0800400700	700	910	24,30														
HFR2S0800400800	800	1010	26,50														
HFR2S0800400900	900	1110	28,80														
HFR2S0800401000	1000	1210	31,00														
ØD 115 ØAL 100 ØS 50				ØD 70 ØAL 60 ØS 35													
HFR2S1000500200	200	425	4,40	1/2"	66	45	75	30,25	60	70		CBF1030060070	CFHR10030063				
HFR2S1000500300	300	525	5,00														
HFR2S1000500400	400	625	5,60														
HFR2S1000500500	500	725	6,20														
HFR2S1000500700	700	925	6,90														
HFR2S1000500900	900	1125	8,10														
HFR2S1000501000	1000	1225	9,30														

MATERIAL:
 TUBE - ROHR: STEEL - STAHL St 52.3 DIN 2393 ISO H9
 ROD - KOLBENSTANGE: STEEL - STAHL UNI C45 SAE 1045 - CHROME - CHROM: 25 MICRON ±5

HM2 | M250

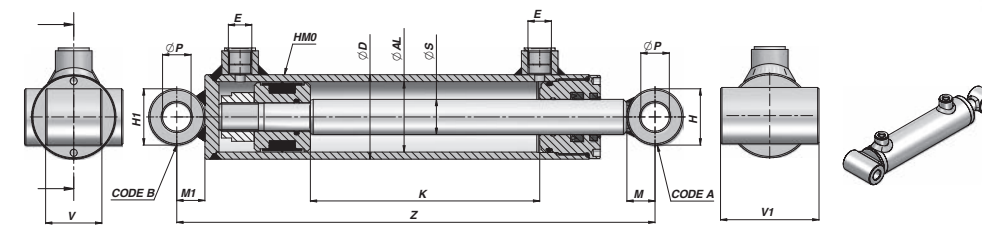
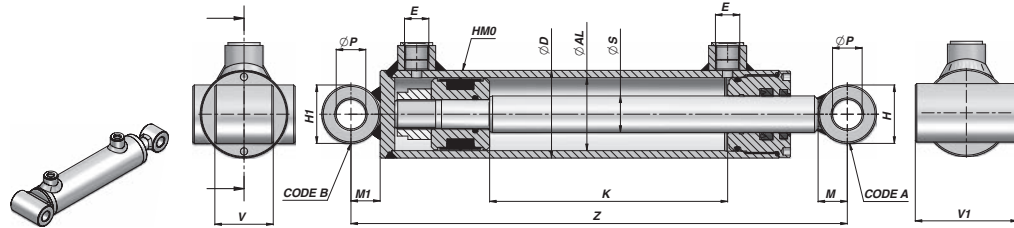

Code Bestell-Nr.	K	Z	kg	E BSP	ØP	H	V	M	H1	V1	M1	Code A	Code B	Code Bestell-Nr.	K	Z	kg										
ØD 42 ØAL 32 ØS 20																											
HM2032200050	50	190	1,88	1/4"	16,25	35	30	17,5	35	60	17,5	CB16035030	CB16035060														
HM2032200100	100	240	2,18																								
HM2032200150	150	290	2,53																								
HM2032200200	200	340	2,88																								
HM2032200250	250	390	3,28																								
HM2032200300	300	440	3,58																								
HM2032200400	400	540	4,28																								
HM2032200500	500	640	4,98																								
ØD 50 ØAL 40 ØS 20																											
HM21200100	100	265	2,85	1/4"	16,25	35	30	17,5	35	60	17,5	CB16035030	CB16035060	HM21250100	100	265	3,08										
HM21200150	150	315	3,25											HM21250150	150	315	3,53										
HM21200200	200	365	3,63											HM21250200	200	365	3,97										
HM21200250	250	415	4,03											HM21250250	250	415	4,43										
HM21200300	300	465	4,43											HM21250300	300	465	4,90										
HM21200350	350	515	4,85											HM21250350	350	515	5,37										
HM21200400	400	565	5,23											HM21250400	400	565	5,84										
HM21200450	450	615	5,66											HM21250450	450	615	6,30										
HM21200500	500	665	6,07											HM21250500	500	665	6,78										
														HM21250550	550	715	7,18										
				HM21250600	600	765	7,71																				
ØD 60 ØAL 50 ØS 25																											
HM22250100	100	280	4,13	3/8"	20,25	40	40	20	40	70	20	CB20040040	CB20040070	HM22300150	150	330	4,95										
HM22250150	150	330	4,67											HM22300200	200	380	5,58										
HM22250200	200	380	5,18											HM22300250	250	430	6,19										
HM22250250	250	430	5,69											HM22300300	300	480	6,81										
HM22250300	300	480	6,19											HM22300350	350	530	7,39										
HM22250350	350	530	6,78											HM22300400	400	580	8,04										
HM22250400	400	580	7,24											HM22300450	450	630	8,64										
HM22250450	450	630	8,14											HM22300500	500	680	9,26										
HM22250500	500	680	8,27											HM22300550	550	730	9,88										
HM22250550	550	730	8,90											HM22300600	600	780	10,48										
HM22250600	600	780	9,30											HM22300700	700	880	11,69										
														HM22300800	800	980	12,94										
HM22250800	800	980	11,55											HM22301000	1000	1180	15,41										
HM22251000	1000	1180	13,71																								
ØD 70 ØAL 60 ØS 30																											
HM23300100	100	310	6,32											3/8"	25,25	50	50	25	50	80	25	CB25050050	CB25050080	HM23350100	100	310	6,57
HM23300150	150	360	7,05	HM23350150	150	360	7,35																				
HM23300200	200	410	7,70	HM23350200	200	410	8,10																				
HM23300250	250	460	8,37	HM23350250	250	460	8,90																				
HM23300300	300	510	9,05	HM23350300	300	510	9,65																				
HM23300350	350	560	9,70	HM23350350	350	560	10,44																				
HM23300400	400	610	10,40	HM23350400	400	610	11,22																				
HM23300450	450	660	11,03	HM23350450	450	660	11,97																				
HM23300500	500	710	11,75	HM23350500	500	710	12,75																				
HM23300550	550	760	12,36	HM23350550	550	760	13,50																				
HM23300600	600	810	13,10	HM23350600	600	810	14,31																				
HM23300800	800	1010	15,76	HM23350800	800	1010	17,37																				
HM23301000	1000	1210	18,50	HM23351000	1000	1210	20,43																				

Code Bestell-Nr.	K	Z	kg	E BSP	ØP	H	V	M	H1	V1	M1	Code A	Code B	Code Bestell-Nr.	K	Z	kg										
ØD 70 ØAL 60 ØS 40																											
HM23400200	200	410	8,75	3/8"	25,25	50	50	25	50	80	25	CB25050050	CB25050080	HM2063400200	200	410	9,11										
HM23400250	250	460	9,64											HM2063400250	250	460	10,01										
HM23400300	300	510	10,53											HM2063400300	300	510	10,91										
HM23400350	350	560	11,40											HM2063400350	350	560	11,81										
HM23400400	400	610	12,29											HM2063400400	400	610	12,71										
HM23400450	450	660	13,14											HM2063400450	450	660	13,61										
HM23400500	500	710	14,02											HM2063400500	500	710	14,51										
HM23400550	550	760	14,95											HM2063400550	550	760	15,41										
HM23400600	600	810	15,80											HM2063400600	600	810	16,31										
HM23400800	800	1010	19,32											HM2063400800	800	1010	20,01										
HM23401000	1000	1210	22,90											HM2063401000	1000	1210	23,61										
ØD 73 ØAL 63 ØS 40																											
ØD 80 ØAL 70 ØS 35																											
HM24350100	100	310	7,60	3/8"	25,25	50	50	25	50	80	25	CB25050050	CB25050080														
HM24350105	150	360	8,46											HM24400200	200	410	9,79										
HM24350200	200	410	9,25											HM24400250	250	460	10,77										
HM24350250	250	460	10,11											HM24400300	300	510	11,75										
HM24350300	300	510	10,91											HM24400350	350	560	12,71										
HM24350350	350	560	11,77											HM24400400	400	610	14,31										
HM24350400	400	610	12,51											HM24400450	450	660	14,62										
HM24350450	450	660	13,39											HM24400500	500	710	15,52										
HM24350500	500	710	14,11											HM24400550	550	760	16,61										
HM24350550	550	760	15,17											HM24400600	600	810	17,50										
HM24350600	600	810	15,71											HM24400600	600	810	17,50										
HM24350800	800	1010	19,07											HM24400800	800	1010	21,24										
HM24351000	1000	1210	22,77											HM24401000	1000	1210	25,02										
ØD 92 ØAL 80 ØS 40																											
HM25400200	200	440	13,91											1/2"	30,25	60	60	30	60	110	30	CB30060060	CB30060110	HM25500200	200	440	15,18
HM25400250	250	490	15,05																					HM25500250	250	490	16,56
HM25400300	300	540	16,18	HM25500300	300	540	17,98																				
HM25400400	400	640	18,39	HM25500400	400	640	20,78																				
HM25400500	500	740	20,60	HM25500500	500	740	23,54																				
HM25400600	600	840	22,81	HM25500600	600	840	26,83																				
HM25400800	800	1040	27,33	HM25500800	800	1040	32,33																				
HM25401000	1000	1240	31,75	HM25501000	1000	1240	37,83																				
ØD 105 ØAL 90 ØS 50																											
HM2090500300	300	556	23,63	1/2"	40,25	70	70	35	70	130	35	CB40070070	CB40070130														
HM2090500400	400	656	26,97																								
HM2090500500	500	756	30,30																								
HM2090500600	600	856	33,63																								
HM2090500800	800	1056	40,30																								
HM2090501000	1000	1256	46,97																								
ØD 115 ØAL 100 ØS 60																											
HM26500200	200	480	23,84	1/2"	40,25	70	70	35	70	130	35	CB40070070	CB40070130														
HM26500250	250	530	25,84											HM26600300	300	580	29,84										
HM26500300	300	580	27,34											HM26600400	400	680	33,84										
HM26500400	400	680	30,84											HM26600500	500	780	37,84										
HM26500500	500	780	34,34											HM26600600	600	880	41,84										
HM26500600	600	880	37,84											HM26600800	800	1080	50,34										
HM26500800	800	1080	44,84											HM26601000	1000	1280	58,84										
HM26501000	1000	1280	51,84																								

MATERIAL:
 TUBE - ROHR: STEEL - STAHL St 52.3 DIN 2393 ISO H9
 ROD - KOLBENSTANGE: STEEL - STAHL UNI C45 SAE 1045 - CHROME - CHROM: 25 MICRON ±5

HM5 | M250

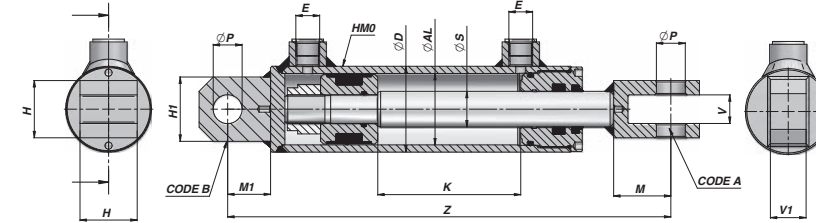
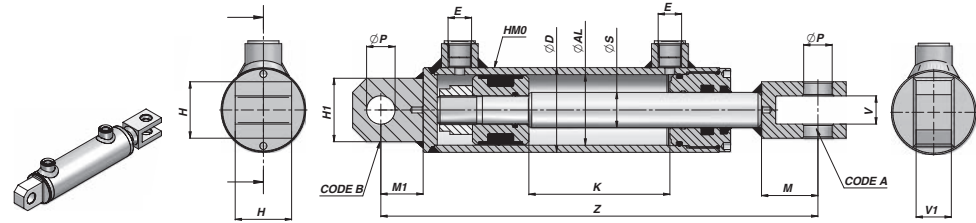

Code Bestell-Nr.	K	Z	kg	E BSP	ØP	H	V	M	H1	V1	M1	Code A	Code B	Code Bestell-Nr.	K	Z	kg
ØD 42 ØAL 32 ØS 20																	
HM5032200050	50	214	1,79	1/4"	16,20	35	16	34	35	20	25	CFS0000016	COF1600000				
HM5032200100	100	364	2,09														
HM5032200150	150	314	2,44														
HM5032200200	200	364	2,79														
HM5032200250	250	414	3,19														
HM5032200300	300	464	3,49														
HM5032200400	400	564	4,19														
HM5032200500	500	664	4,89														
ØD 50 ØAL 40 ØS 20																	
HM51200100	100	289	2,76	1/4"	16,20	35	16	34	35	20	25	CFS0000016	COF1600000	HM51250100	100	289	2,99
HM51200150	150	339	3,16											HM51250150	150	339	3,44
HM51200200	200	389	3,54											HM51250200	200	389	3,88
HM51200250	250	439	3,94											HM51250250	250	439	4,34
HM51200300	300	489	4,34											HM51250300	300	489	4,81
HM51200350	350	539	4,76											HM51250350	350	539	5,28
HM51200400	400	589	5,14											HM51250400	400	589	5,75
HM51200450	450	639	5,57											HM51250450	450	639	6,21
HM51200500	500	689	5,98											HM51250500	500	689	6,69
														HM51250550	550	739	7,09
				HM51250600	600	789	7,62										
ØD 60 ØAL 50 ØS 25																	
HM52250100	100	310	4,07	3/8"	20,25	40	20	40	45	25	30	CFS0000020	COF0000000	HM52300150	150	360	4,89
HM52250150	150	360	4,61											HM52300200	200	410	5,52
HM52250200	200	410	5,12											HM52300250	250	460	6,13
HM52250250	250	460	5,63											HM52300300	300	510	6,75
HM52250300	300	510	6,13											HM52300350	350	560	7,33
HM52250350	350	560	6,72											HM52300400	400	610	7,98
HM52250400	400	610	7,18											HM52300450	450	660	8,58
HM52250450	450	660	8,08											HM52300500	500	710	9,20
HM52250500	500	710	8,21											HM52300550	550	760	9,82
HM52250550	550	760	8,84											HM52300600	600	810	10,42
HM52250600	600	810	9,24											HM52300700	700	910	11,63
														HM52300800	800	1010	12,88
														HM52301000	1000	1210	15,35
ØD 60 ØAL 50 ØS 30																	
HM52250800	800	1010	11,19														
HM52251000	1000	1210	13,65														
ØD 70 ØAL 60 ØS 30																	
HM53300100	100	340	6,14	3/8"	25,25	50	25	45	50	30	35	CFS0000025	COF2500000	HM53350100	100	340	6,39
HM53300150	150	390	6,87											HM53350150	150	390	7,17
HM53300200	200	440	7,52											HM53350200	200	440	7,92
HM53300250	250	490	8,19											HM53350250	250	490	8,72
HM53300300	300	540	8,87											HM53350300	300	540	9,47
HM53300350	350	590	9,52											HM53350350	350	590	10,26
HM53300400	400	640	10,22											HM53350400	400	640	11,04
HM53300450	450	690	10,85											HM53350450	450	690	11,79
HM53300500	500	740	11,57											HM53350500	500	740	12,57
HM53300550	550	790	12,18											HM53350550	550	790	13,32
HM53300600	600	840	12,92											HM53350600	600	840	14,13
HM53300800	800	1040	15,58											HM53350800	800	1040	17,19
HM53301000	1000	1240	18,32											HM53351000	1000	1240	20,25

Code Bestell-Nr.	K	Z	kg	E BSP	ØP	H	V	M	H1	V1	M1	Code A	Code B	Code Bestell-Nr.	K	Z	kg										
ØD 70 ØAL 60 ØS 40																											
HM53400200	200	440	8,57	3/8"	25,25	50	25	45	50	30	35	CFS0000025	COF2500000	HM5063400200	200	440	8,93										
HM53400250	250	490	9,46											HM5063400250	250	490	9,83										
HM53400300	300	540	10,35											HM5063400300	300	540	10,73										
HM53400350	350	590	11,22											HM5063400350	350	590	11,63										
HM53400400	400	640	12,11											HM5063400400	400	640	12,53										
HM53400450	450	690	12,96											HM5063400450	450	690	13,43										
HM53400500	500	740	13,84											HM5063400500	500	740	14,33										
HM53400550	550	790	14,77											HM5063400550	550	790	15,23										
HM53400600	600	840	15,62											HM5063400600	600	840	16,13										
HM53400800	800	1040	19,14											HM5063400800	800	1040	19,83										
HM53401000	1000	1240	22,72	HM5063401000	1000	1240	23,43																				
ØD 80 ØAL 70 ØS 35																											
HM54350100	100	340	7,42	3/8"	25,25	50	25	45	50	30	35	CFS0000025	COF2500000														
HM54350105	150	390	8,28																								
HM54350200	200	440	9,07											HM54400200	200	440	9,61										
HM54350250	250	490	9,93											HM54400250	250	490	10,59										
HM54350300	300	540	10,73											HM54400300	300	540	11,57										
HM54350350	350	590	11,59											HM54400350	350	590	12,53										
HM54350400	400	640	12,33											HM54400400	400	640	14,13										
HM54350450	450	690	13,21											HM54400450	450	690	14,44										
HM54350500	500	740	13,93											HM54400500	500	740	15,34										
HM54350550	550	790	14,99											HM54400550	550	790	16,43										
HM54350600	600	840	15,53	HM54400600	600	840	17,32																				
HM54350800	800	1040	18,89	HM54400800	800	1040	21,06																				
HM54351000	1000	1240	22,59	HM54401000	1000	1240	24,84																				
ØD 92 ØAL 80 ØS 40																											
HM55400200	200	475	13,22	1/2"	30,25	60	30	50	60	35	45	CFS0000030	COF3000000	HM55500200	200	475	14,49										
HM55400250	250	525	14,36											HM55500250	250	525	15,87										
HM55400300	300	575	15,49											HM55500300	300	575	17,29										
HM55400400	400	675	17,70											HM55500400	400	675	20,09										
HM55400500	500	775	19,91											HM55500500	500	775	22,85										
HM55400600	600	875	22,12											HM55500600	600	875	26,14										
HM55400800	800	1075	26,64											HM55500800	800	1075	31,64										
HM55401000	1000	1275	31,06											HM55501000	1000	1275	37,14										
ØD 105 ØAL 90 ØS 50																											
HM5090500300	300	616	23,58											1/2"	40,25	80	40	70	70	40	60	CFS0000040	COF4000000				
HM5090500400	400	716	26,92																								
HM5090500500	500	816	30,25																								
HM5090500600	600	916	33,58																								
HM5090500800	800	1116	40,25																								
HM5090501000	1000	1316	46,92																								
ØD 115 ØAL 100 ØS 60																											
HM56500200	200	540	23,79	1/2"	40,25	80	40	70	70	40	60	CFS0000040	COF4000000														
HM56500250	250	590	25,79																								
HM56500300	300	640	27,29																								
HM56500400	400	740	30,79											HM56600300	300	640	29,79										
HM56500500	500	840	34,29											HM56600400	400	740	33,79										
HM56500600	600	940	37,79											HM56600500	500	840	37,79										
HM56500800	800	1140	44,79											HM56600600	600	940	41,79										
HM56501000	1000	1340	51,79											HM56600800	800	1140	50,29										
														HM56601000	1000	1340	58,79										

MATERIAL:
 TUBE - ROHR: STEEL - STAHL St 52.3 DIN 2393 ISO H9
 ROD - KOLBENSTANGE: STEEL - STAHL UNI C45 SAE 1045 - CHROME - CHROM: 25 MICRON ±5

HMB | M250

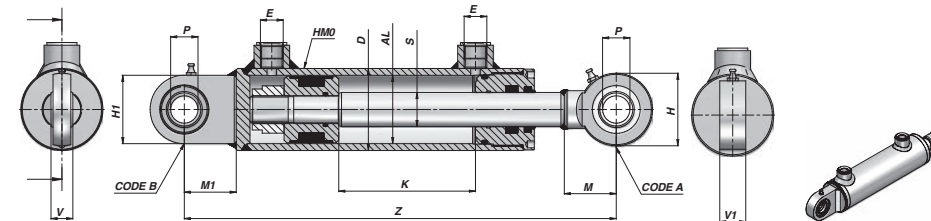
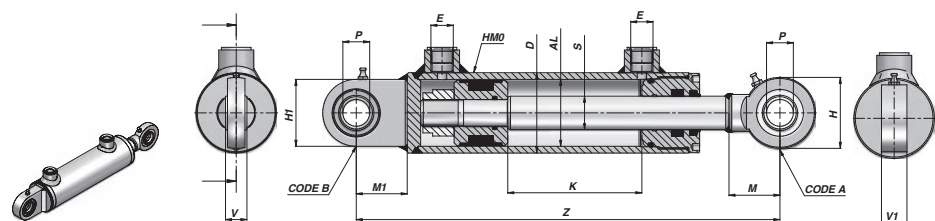

Code Bestell-Nr.	K	Z	kg	E BSP	ØP	H	V	M	H1	V1	M1	Code A	Code B	Code Bestell-Nr.	K	Z	kg										
ØD 42 ØAL 32 ØS 20																											
HMB032200050	50	225	1,80	1/4"	16	46	14	5	48	17,5	35	CSTS016C00	CSTS016N00														
HMB032200100	100	275	2,10																								
HMB032200150	150	325	2,45																								
HMB032200200	200	375	2,80																								
HMB032200250	250	425	3,20																								
HMB032200300	300	475	3,50																								
HMB032200400	400	575	4,20																								
HMB032200500	500	675	4,90																								
ØD 50 ØAL 40 ØS 20																											
HMB1200100	100	300	2,77	1/4"	16	46	14	35	48	17,5	35	CSTS016C00	CSTS016N00	HMB1250100	100	300	3,00										
HMB1200150	150	350	3,17											HMB1250150	150	350	3,45										
HMB1200200	200	400	3,55											HMB1250200	200	400	3,89										
HMB1200250	250	450	3,95											HMB1250250	250	450	4,35										
HMB1200300	300	500	4,35											HMB1250300	300	500	4,82										
HMB1200350	350	550	4,77											HMB1250350	350	550	5,29										
HMB1200400	400	600	5,15											HMB1250400	400	600	5,76										
HMB1200450	450	650	5,58											HMB1250450	450	650	6,22										
HMB1200500	500	700	5,99											HMB1250500	500	700	6,70										
														HMB1250550	550	750	7,10										
														HMB1250600	600	800	7,63										
ØD 60 ØAL 50 ØS 25																											
HMB2250100	100	316	3,49	3/8"	20	53	16	38	50	19	38	CSTS020C00	CSTS020N00	HMB2300150	150	366	4,76										
HMB2250150	150	366	4,48											HMB2300200	200	416	5,39										
HMB2250200	200	416	4,99											HMB2300250	250	466	6,00										
HMB2250250	250	466	5,50											HMB2300300	300	516	6,62										
HMB2250300	300	516	6,00											HMB2300350	350	566	7,20										
HMB2250350	350	566	6,59											HMB2300400	400	616	7,85										
HMB2250400	400	616	7,05											HMB2300450	450	666	8,45										
HMB2250450	450	666	7,95											HMB2300500	500	716	9,07										
HMB2250500	500	716	8,08											HMB2300550	550	766	9,69										
HMB2250550	550	766	8,71											HMB2300600	600	816	10,29										
HMB2250600	600	816	9,11											HMB2300700	700	916	11,50										
														HMB2300800	800	1016	12,75										
HMB2250800	800	1016	11,36											HMB2301000	1000	1216	15,22										
HMB2251000	1000	1216	13,52																								
ØD 70 ØAL 60 ØS 30																											
HMB3300100	100	350	5,85											3/8"	25	64	20	45	55	23	45	CSTS025C00	CSTS025N00	HMB3350100	100	350	6,10
HMB3300150	150	400	6,58																					HMB3350150	150	400	6,88
HMB3300200	200	450	7,23																					HMB3350200	200	450	7,63
HMB3300250	250	500	7,90																					HMB3350250	250	500	8,43
HMB3300300	300	550	8,58																					HMB3350300	300	550	9,18
HMB3300350	350	600	9,23	HMB3350350	350	600	9,97																				
HMB3300400	400	650	9,93	HMB3350400	400	650	10,75																				
HMB3300450	450	700	10,56	HMB3350450	450	700	11,50																				
HMB3300500	500	750	11,28	HMB3350500	500	750	12,28																				
HMB3300550	550	800	11,89	HMB3350550	550	800	13,03																				
HMB3300600	600	850	12,63	HMB3350600	600	850	13,84																				
HMB3300800	800	1050	15,29	HMB3350800	800	1050	16,90																				
HMB3301000	1000	1250	18,03	HMB3351000	1000	1250	19,96																				

Code Bestell-Nr.	K	Z	kg	E BSP	ØP	H	V	M	H1	V1	M1	Code A	Code B	Code Bestell-Nr.	K	Z	kg										
ØD 70 ØAL 60 ØS 40																											
HMB3400200	200	450	8,28	3/8"	25	64	20	45	55	23	45	CSTS025C00	CSTS025N00	HMB063400200	200	450	8,64										
HMB3400250	250	500	9,17											HMB063400250	250	500	9,54										
HMB3400300	300	550	10,06											HMB063400300	300	550	10,44										
HMB3400350	350	600	10,93											HMB063400350	350	600	11,34										
HMB3400400	400	650	11,82											HMB063400400	400	650	12,24										
HMB3400450	450	700	12,67											HMB063400450	450	700	13,14										
HMB3400500	500	750	13,55											HMB063400500	500	750	14,04										
HMB3400550	550	800	14,48											HMB063400550	550	800	14,94										
HMB3400600	600	850	15,33											HMB063400600	600	850	15,84										
HMB3400800	800	1050	18,85											HMB063400800	800	1050	19,54										
HMB3401000	1000	1250	22,43											HMB063401000	1000	1250	23,14										
ØD 80 ØAL 70 ØS 35																											
HMB4350100	100	350	7,13											3/8"	25	64	20	45	55	23	45	CSTS025C00	CSTS025N00	HMB4400200	200	450	9,32
HMB4350105	150	400	7,99																					HMB4400250	250	500	10,30
HMB4350200	200	450	8,78	HMB4400300	300	550	11,28																				
HMB4350250	250	500	9,64	HMB4400350	350	600	12,24																				
HMB4350300	300	550	10,44	HMB4400400	400	650	13,84																				
HMB4350350	350	600	11,30	HMB4400450	450	700	14,15																				
HMB4350400	400	650	12,04	HMB4400500	500	750	15,05																				
HMB4350450	450	700	12,92	HMB4400550	550	800	16,14																				
HMB4350500	500	750	13,64	HMB4400600	600	850	17,03																				
HMB4350550	550	800	14,70	HMB4400600	600	850	17,03																				
HMB4350600	600	850	15,24	HMB4400800	800	1050	20,77																				
HMB4350800	800	1050	18,60	HMB4401000	1000	1250	24,55																				
HMB4351000	1000	1250	22,30																								
ØD 92 ØAL 80 ØS 40																											
HMB5400200	200	482	12,67	1/2"	30	73	22	51	65	28	51	CSTS030C00	CSTS030N00											HMB5500200	200	482	13,94
HMB5400250	250	532	13,81																					HMB5500250	250	532	15,32
HMB5400300	300	582	14,94																					HMB5500300	300	582	16,74
HMB5400400	400	682	17,15																					HMB5500400	400	682	19,54
HMB5400500	500	782	19,36											HMB5500500	500	782	22,30										
HMB5400600	600	882	21,75											HMB5500600	600	882	25,59										
HMB5400800	800	1082	26,09											HMB5500800	800	1082	31,09										
HMB5401000	1000	1282	30,51											HMB5501000	1000	1282	36,59										
ØD 105 ØAL 90 ØS 50																											
HMB090500300	300	624	23,26											1/2"	40	92	28	69	100	35	69	CSTS040C00	CSTS040N00				
HMB090500400	400	724	26,60																								
HMB090500500	500	824	29,93																								
HMB090500600	600	924	33,26																								
HMB090500800	800	1124	39,93																								
HMB090501000	1000	1324	46,60																								
ØD 115 ØAL 100 ØS 60																											
HMB6500200	200	548	23,47	1/2"	40	92	28	69	100	35	69	CSTS040C00	CSTS040N00	HMB6600300	300	648	29,47										
HMB6500250	250	598	25,47											HMB6600400	400	748	33,47										
HMB6500300	300	648	26,47											HMB6600500	500	848	37,47										
HMB6500400	400	748	30,47											HMB6600600	600	948	41,47										
HMB6500500	500	848	33,97											HMB6600800	800	1148	49,47										
HMB6500600	600	948	37,47											HMB6601000	1000	1348	58,47										
HMB6500800	800	1148	44,47																								
HMB6501000	1000	1348	51,47																								

MATERIAL:
TUBE - ROHR: STEEL - STAHL St 52.3 DIN 2393 ISO H9
ROD - KOLBENSTANGE: STEEL - STAHL UNI C45 SAE 1045 - CHROME - CHROM: 25 MICRON ±5

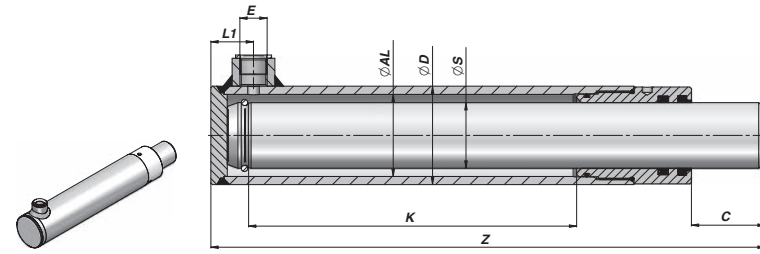

Code Bestell-Nr.	K	Z	kg	E BSP	L1	C
ØD 50 ØAL 40 ØS 30						
HT2300200	200	326	3,64	3/8"	23	40
HT2300250	250	376	4,19			
HT2300300	300	426	4,75			
HT2300350	350	476	5,31			
HT2300400	400	526	5,86			
HT2300500	500	626	6,96			
ØD 60 ØAL 50 ØS 40						
HT03400200	200	338	5,64	3/8"	26	45
HT03400300	300	438	7,29			
HT03400400	400	538	8,98			
HT03400500	500	638	10,61			
HT03400600	600	738	12,28			
ØD 70 ØAL 60 ØS 50						
HT04500300	300	450	10,47	3/8"	30	50
HT04500400	400	550	12,86			
HT04500500	500	650	15,14			
HT04500600	600	750	17,50			

MATERIALE - MATERIAL:
 TUBE - ROHR: STEEL - STAHL St 52.3 DIN 2393 ISO H9
 ROD - KOLBENSTANGE: STEEL - STAHL UNI C45 SAE 1045 - CHROME - CHROM: 25 MICRON ±5

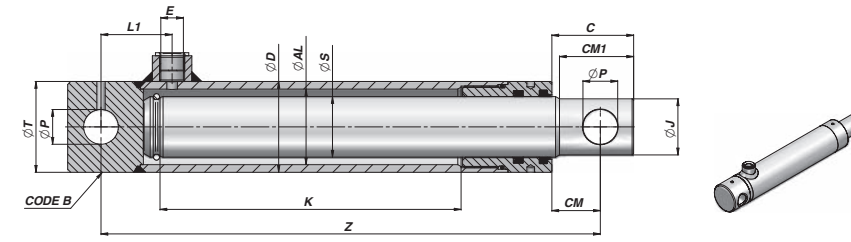

Code Bestell-Nr.	K	Z	kg	E BSP	L1	ØP	CM	C	ØJ	CM1	ØT	Code B
ØD 40 ØAL 30 ØS 25												
HFRT125100	100	190	1,63	3/8"	40	14	24	38	22	35	40	CFHRT04030
HFRT125150	150	240	2,04									
HFRT125200	200	290	2,44									
HFRT125250	250	340	2,85									
HFRT125300	300	390	3,26									
ØD 50 ØAL 40 ØS 30												
HFRT230200	200	300	3,61	3/8"	42	16	26	42	27	37	50	CF04005016
HFRT230250	250	350	4,16									
HFRT230300	300	400	4,72									
HFRT230350	350	450	5,27									
HFRT230400	400	500	5,82									
HFRT230550	550	650	7,30									
ØD 60 ØAL 50 ØS 40												
HFRT340200	200	330	6,00	3/8"	47	23	32	54	37	49	60	CFHRT06050
HFRT340250	250	380	6,84									
HFRT340300	300	430	7,67									
HFRT340350	350	480	8,49									
HFRT340400	400	530	9,32									
HFRT340550	550	680	11,40									
HFRT340700	700	830	14,10									
ØD 70 ØAL 60 ØS 50												
HFRT450300	300	460	11,80	3/8"	50	25,5	49	74	47	65	65	CFHRT07060
HFRT450400	400	560	14,00									
HFRT450550	550	710	17,50									
HFRT450700	700	860	21,00									

MATERIALE - MATERIAL:
 TUBE - ROHR: STEEL - STAHL St 52.3 DIN 2393 ISO H9
 ROD - KOLBENSTANGE: STEEL - STAHL UNI C45 SAE 1045 - CHROME - CHROM: 25 MICRON ±5

IP-CF

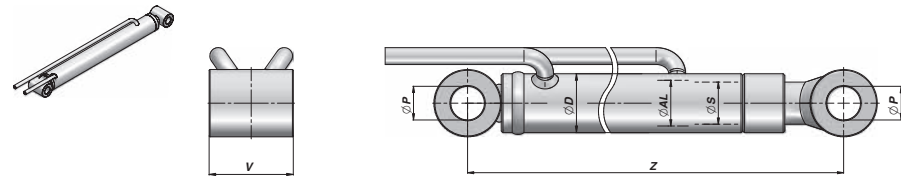

Code Bestell-Nr.	ØD	ØAL	ØS	Stroke Hub	Z	ØP (+0.2 +0.3)	F	LF1	kg	Fork Gabel	Lockable Pin Halteclip
IP07CEN2515002	30	25	20	1500	1650	20	M14x2	35	7,30		
IP07CEN2512002	30	25	20	1200	1350	20	M14x2	35	6,10		
IP07CEN2510002	30	25	20	1000	1150	20	M14x2	35	5,30	CFF012334	CFF012334
IP07CEN2508002	30	25	20	800	950	20	M14x2	35	4,40		
IP07CEN2506002	30	25	20	600	750	20	M14x2	35	3,60		

MAX. PRESSURE - MAX. DRUCK: 180 BAR
 TEMPERATURE C° - TEMPERATURBEREICH C°: -15°C - +70°C
 MAX. SPEED - HÖCHSTGESCHWINDIGKEIT: MAX 0,5 M/S

IP-CB

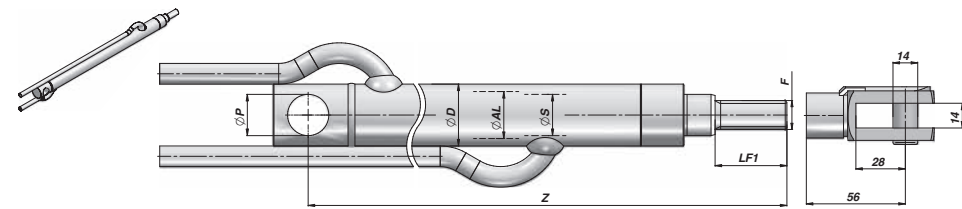

Code Bestell-Nr.	ØD	ØAL	ØS	Stroke Hub	Z	ØP	V	kg
IP07CEN4015000	50	40	25	1500	1670	20,5	55	17,5

MAX. PRESSURE - MAX. DRUCK: 180 BAR
 TEMPERATURE C° - TEMPERATURBEREICH C°: -15°C - +70°C
 MAX. SPEED - HÖCHSTGESCHWINDIGKEIT: MAX 0,5 M/S

IP-F

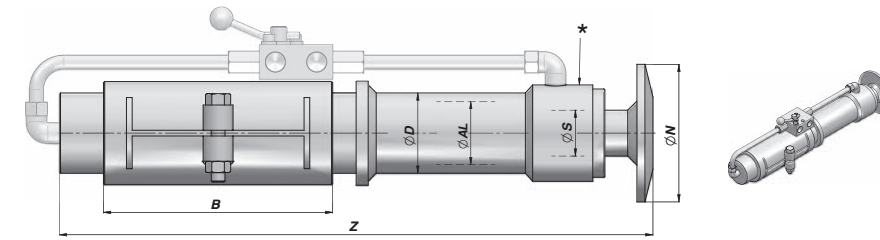

Code Bestell-Nr.	ØD	ØAL	ØS	Stroke Hub	Z	B	ØN	kg	Check Valve Sperrventil BSP
IP07CS0400AC00 *	50	40	25	250	395	150	80	5,10	-
IP07CS0400ACB0 *	50	40	25	250	395	150	80	6,10	1/4"
IP07CS0600AC00 *	70	60	40	360	530	200	120	13,50	-
IP07CS0600ACB0 *	70	60	40	360	530	200	120	14,60	3/8"
IP07CS0700AC00 *	85	70	50	450	635	220	150	24,50	-
IP07CS0700ACB0 *	85	70	50	450	635	220	150	25,70	3/8"
IP07CS0800AC00	95	80	60	500	705	220	150	37,10	-
IP07CS0800ACB0	95	80	60	500	705	220	150	38,30	3/8"
IP07CS0900AC00	105	90	70	600	795	260	200	54,00	-
IP07CS0900ACB0	105	90	70	600	795	260	200	55,30	1/2"
IP07CS1100AC00	125	110	90	500	715	260	200	71,50	-
IP07CS1100ACB0	125	110	90	500	715	260	200	72,80	1/2"

* = Without reinforcing collar - Ohne Verstärkungsring

MAX. PRESSURE - MAX. DRUCK: 180 BAR
 TEMPERATURE C° - TEMPERATURBEREICH C°: -15°C - +70°C
 MAX. SPEED - HÖCHSTGESCHWINDIGKEIT: MAX 0,5 M/S

IP-S

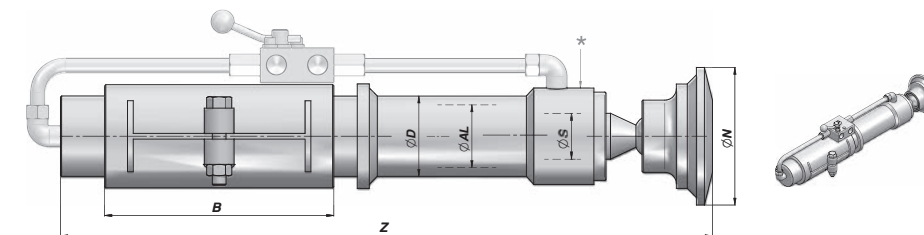

Code Bestell-Nr.	ØD	ØAL	ØS	Stroke Hub	Z	B	ØN	kg	Check Valve Sperrventil BSP
IP07CS0600BC00 *	70	60	40	360	580	200	120	15,40	-
IP07CS0600BCB0 *	70	60	40	360	580	200	120	16,50	3/8"
IP07CS0700BC00 *	85	70	50	450	678	220	150	25,60	-
IP07CS0700BCB0 *	85	70	50	450	678	220	150	26,70	3/8"
IP07CS0800BC00	95	80	60	500	767	220	150	39,00	-
IP07CS0800BCB0	95	80	60	500	767	220	150	40,20	3/8"
IP07CS0900BC00	105	90	70	600	857	260	200	57,20	-
IP07CS0900BCB0	105	90	70	600	857	260	200	58,50	1/2"
IP07CS1100BC00	125	110	90	500	787	260	200	73,30	-
IP07CS1100BCB0	125	110	90	500	787	260	200	74,60	1/2"

* = Without reinforcing collar - Ohne Verstärkungsring

MAX. PRESSURE - MAX. DRUCK: 180 BAR
 TEMPERATURE C° - TEMPERATURBEREICH C°: -15°C - +70°C
 MAX. SPEED - HÖCHSTGESCHWINDIGKEIT: MAX 0,5 M/S

IH

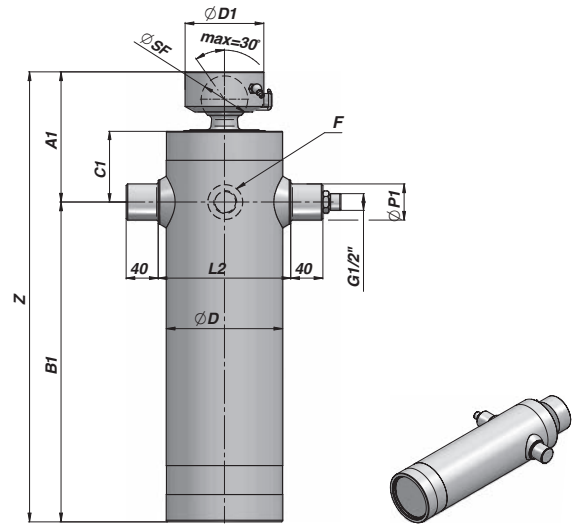

Code Bestell-Nr.	New Model Neue Bezeichnung	Old Model Alte Bez.	Extensions / Stufenzahl	Stroke Hub	Oil Consumption			Z	A1	B1	C1	Ø D1	Ø SF	Ø P1	Ø D	L2	F BSP	kg
					dm³	bar	ton											
IH3102751054002	BL275 823 105 4 CRL	LB06/4	4	823	4,6	200	10,4	360	151	209	95	85	43	40	125	148	-	22
IH3103550753002	BL355 851 75 3 CRL	L02/355/3	3	851	25	220	6,1	435	150	285	95	85	43	35	95	120	-	19
IH3103601203002	BL360 861 1210 3 CRL	L08/3	3	861	7,7	200	17,6	475	199	276	125	120	58	45	145	165	1/2"	32
IH3103600903002	BL360 866 90 3 CRL	L04/3	3	866	3,9	220	9,6	442	155	287	100	85	43	40	110	148	-	23
IH3103601053002	BL360 870 105 3 CRL	L06/3Z	3	870	5,6	200	12,7	462	168	294	95	120	58	40	125	170	1/2"	27
IH3103201054002	BL320 1003 105 4 CRL	L06/4	4	1003	5,6	200	10,4	405	151	254	95	85	43	40	125	148	-	27
IH3102751055002	BL275 1027 105 5 CRL	LB06/5	5	1027	4,9	200	8,3	361	152	209	95	85	43	40	125	148	-	23
IH3104250903002	BL425 1061 90 3 CRL	L04/425/3	3	1061	4,8	220	9,6	524	155	369	83	120	58	40	110	148	-	27
IH3104250753002	BL425 1061 75 3 CRL	L02/427/3	3	1061	3,1	220	6,1	505	150	355	95	85	43	35	95	120	-	21
IH3103601054002	BL360 1153 105 4 CRL	L06/4Z	4	1153	6,4	200	10,4	462	168	294	95	120	58	40	125	148	-	28
IH3103601204002	BL360 1154 120 4 CRL	L08/4	4	1154	9,0	200	14,9	475	199	276	125	120	58	45	145	165	-	38
IH3103600904002	BL360 1155 90 4 CRL	L04/4	4	1155	4,4	220	7,5	443	156	287	100	85	43	40	110	148	-	24
IH3103001205002	BL300 1156 120 5 CRL	LB08/5	5	1156	7,9	200	12,3	415	199	216	125	120	58	45	145	165	-	39
IH3104750903002	BL475 1211 90 3 CRL	L04/475/3	3	1211	5,5	220	9,6	574	180	394	108	120	58	40	110	148	-	34
IH3103201055002	BL320 1252 105 5 CRL	L06/5	5	1252	6,0	200	8,3	406	152	254	95	85	43	40	125	148	-	28
IH3104101204002	BL410 1354 120 4 CRL	L08/420/4	4	1354	10,5	200	14,9	525	234	291	160	120	58	45	145	165	-	52
IH3103601205002	BL360 1437 120 5 CRL	L08/5	5	1437	9,8	200	12,3	475	199	276	125	120	58	45	145	165	-	40
IH3103601055002	BLL360 1443 105 5CRL	L06/5Z	5	1443	6,9	200	8,3	446	152	294	95	85	43	40	125	148	-	29
IH3104401204002	BL440 1474 120 4 CRL	L08/450/4	4	1474	11,4	200	14,9	555	162	393	88	120	58	45	145	165	-	56
IH3104451054002	BL445 1493 105 4 CRL	L06/450/4	4	1493	8,3	200	10,4	547	156	391	83	120	58	40	125	148	-	35
IH3104101205002	BL410 1687 120 5 CRL	L08/420/5	5	1687	11,4	200	12,3	525	234	291	160	120	58	45	145	165	-	47
IH3104401205002	BL440 1837 120 5 CRL	L08/450/5	5	1837	12,5	200	12,3	555	162	393	88	120	58	45	145	165	-	51
IH3104451055002	BL445 1868 105 5 CRL	L06/450/5	5	1868	8,9	200	8,3	531	140	391	83	85	43	40	125	148	-	38

Cylinder with chrome-coated telescopic moving stages - Teleskopzylinder mit verchromten Stufen



IH-SC

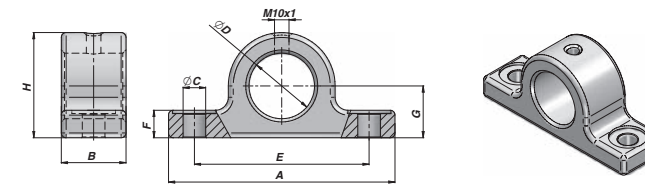

Code Bestell-Nr.	Ref.	A	B	ØC	ØD	E	F	G	H	kg
IHA70035001	SC35	140	40	14	35,5	108	17	32	65	1,5
IHA70040001	SC40	140	40	14	40,5	108	17	32	65	1,5
IHA70045001	SC45	140	40	14	45,5	108	17	32	65	1,5

LAGER FÜR KARDANRING | CRADLE SUPPORT

IH-SB

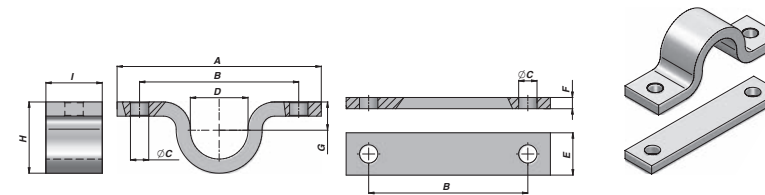

Code Bestell-Nr.	Ref.	A	B	ØC	ØD	E	F	G	H	I	kg
IHA60035001	SB35	145	113	13	35,5	30	8	18	46	40	1,0
IHA60040001	SB40	145	113	13	40,5	30	8	20	51	40	1,0
IHA60045001	SB45	145	113	13	45,5	30	8	23	56	40	1,0

KARDANRING | CRADLE

IH-L

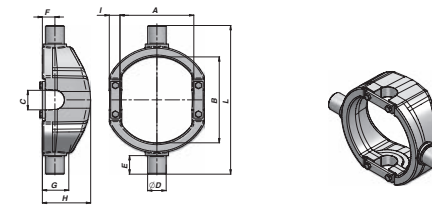

Code Bestell-Nr.	Ref.	Max Capacity Max Tragkraft ton	A	B	ØC	ØD	E	F	G	H	I	L	kg
IHA5L080001	L08	11	167	215	45	45	45	30	90	115	35	360	11,5
IHA5L060001	L06-L04	8	150	185	40	40	40	27	68	105	20	320	9,0
IHA5L020001	L02	4	125	165	36,5	35	37,5	27	62	76	20	275	5,5



Full range of FRONT MOUNT and UNDER BODY CYLINDERS for MEDIUM and HEAVY DUTY also available.

Breite Palette von FRONTHEBEZYLINDERN und UNTERFLURZYLINDERN zu MITTEL- UND SCHWERANWENDUNG auch verfügbar.

IM - T64

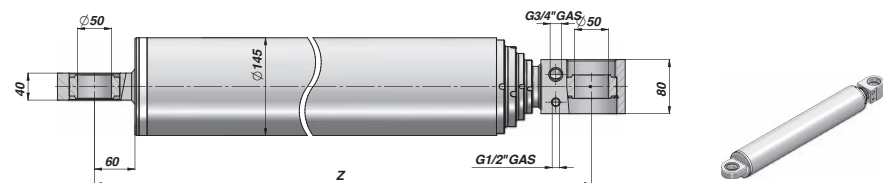

Code Bestell-Nr.	Serie	Extensions Stufenzahl	Stroke Hub	Max Working Pressure Maximumbetriebsdruck		Z	kg
				bar			
IMT641600800	T64/160	4	1850	160		800	59
IMT641601000	T64/160	4	2650	160		1000	74
IMT641601100	T64/160	4	3050	160		1100	81
IMT641601200	T64/160	4	3450	160		1200	88

IM - T555

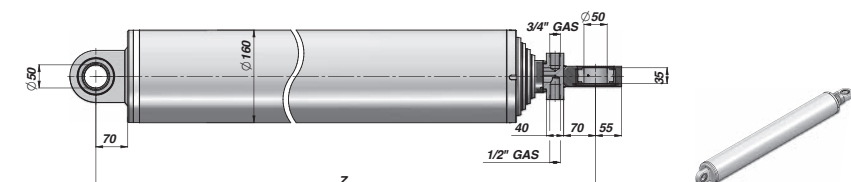

Code Bestell-Nr.	Serie	Extensions Stufenzahl	Stroke Hub	Max Working Pressure Maximumbetriebsdruck		Z	kg
				bar			
IMT555200	T555/200	5	4395	200		1300	130
IMT555200	T555/200	5	4845	200		1400	141
IMT555200	T555/200	5	5295	200		1500	151

IM - T96

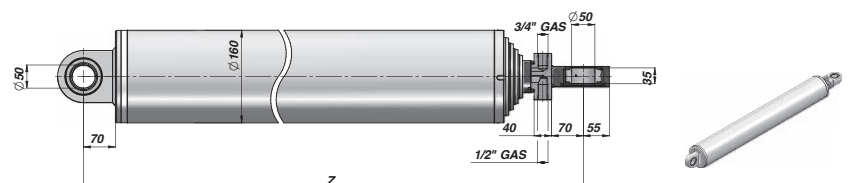

Code Bestell-Nr.	Serie	Extensions Stufenzahl	Stroke Hub	Max Working Pressure Maximumbetriebsdruck		Z	kg
				bar			
IMT96150	T96/150	6	8000	150		1870	392
IMT96150	T96/150	6	9000	150		2030	426
IMT96150	T96/150	6	10000	150		2190	460

IC

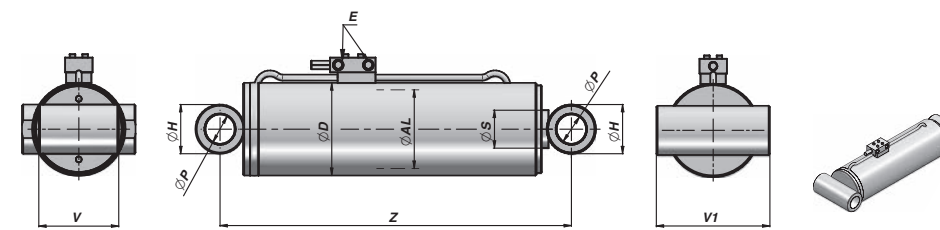

Code Bestell-Nr.	ØD	ØAL	ØS	Stroke Hub	Z	E BSP	ØP	ØH	V	V1	kg
IC8106801901001	220	190	90	550	835	1/2"	70	117	190	270	145

MAX. PRESSURE - MAX. DRUCK: 350 BAR

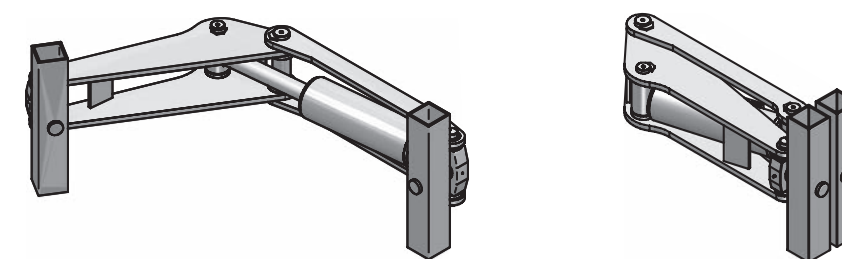

STL | M250

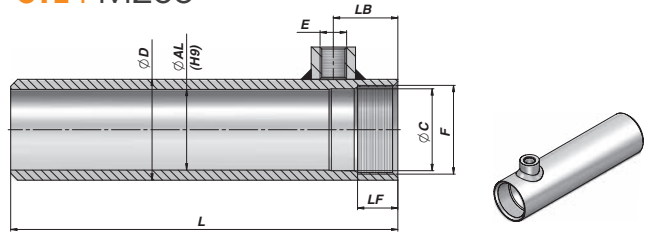

Code Bestell-Nr.	ØAL	Stroke Hub	L	ØD	E BSP	LB	F	LF	ØC	kg							
STFR025050050	25	50	95	35	1/4"	15	M28x1,5	13	-	0,40							
STFR025050100		100	145							0,60							
STFR025050150		150	195							0,70							
STFR025050200		200	245							0,90							
STFR032050050	32	50	127	42	1/4"	27	M36x1,5	16	32,6	0,60							
STFR032050100		100	177							0,80							
STFR032050150		150	227							1,00							
STFR032050200		200	277							1,30							
STFR032050250		250	327							1,50							
STFR032050300		300	377							1,70							
STFR032050400		400	477							2,20							
STFR032050500		500	577							2,60							
STL1500100		40	100							192	50	1/4"	32	M44x1,5	20	40,6	1,09
STL1500150			150							242							1,37
STL1500200	200		292	1,64													
STL1500250	250		342	1,92													
STL1500300	300		392	2,19													
STL1500350	350		442	2,47													
STL1500400	400		492	2,74													
STL1500450	450		542	3,02													
STL1500500	500		592	3,30													
STL1500550	550		642	3,57													
STL1500600	600		692	3,85													
STL2500100	50		100	202	60	3/8"	35	M54x1,5	23	50,6							1,40
STL2500150			150	252													1,74
STL2500200			200	302													2,08
STL2500250			250	352													2,42
STL2500300			300	402													2,75
STL2500350		350	452	3,09													
STL2500400		400	502	3,43													
STL2500450		450	552	3,76													
STL2500500		500	602	4,10													
STL2500550		550	652	4,44													
STL2500600		600	702	4,77													
STL2500700		700	802	5,44													
STL2500800		800	902	6,12													
STL2501000		1000	1102	7,47													
STL3501500		1500	1602	10,17													
STL3500100		60	100	217							70	3/8"	40	M64x1,5	28	60,6	1,77
STL3500150	150		267	2,17													
STL3500200	200		317	2,57													
STL3500250	250		367	2,97													
STL3500300	300		417	3,36													
STL3500350	350		467	3,76													
STL3500400	400		517	4,16													
STL3500450	450		567	4,56													
STL3500500	500		617	4,96													
STL3500550	550		667	5,35													
STL3500600	600		717	5,75													
STL3500800	800		917	7,35													
STL3501000	1000		1117	8,94													
STL3501500	1500		1617	12,95													

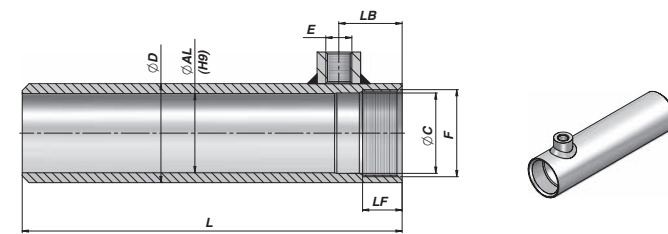

Code Bestell-Nr.	ØAL	Stroke Hub	L	ØD	E BSP	LB	F	LF	ØC	kg							
STL0630730200	63	200	317	73	3/8"	40	M68x1,5	26	64,1	2,59							
STL0630730250		250	367							3,01							
STL0630730300		300	417							3,43							
STL0630730400		400	517							4,27							
STL0630730500		500	617							5,11							
STL0630730600		600	717							5,95							
STL0630730800		800	917							7,63							
STL0630731000		1000	1117							9,30							
STL4500100		70	100							217	80	3/8"	40	M74x1,5	28	70,6	2,04
STL4500150			150							267							2,50
STL4500200	200		317	2,96													
STL4500250	250		367	3,42													
STL4500300	300		417	3,87													
STL4500350	350		467	4,33													
STL4500400	400		517	4,79													
STL4500450	450		567	5,25													
STL4500500	500		617	5,71													
STL4500550	550		667	6,17													
STL4500600	600		817	6,63													
STL4500800	800		917	8,47													
STL4501000	1000		1117	10,31													
STL4501500	1500		1617	14,94													
STL5600200	80		200	335	92	1/2"	50	M85x2	34	80,6							4,29
STL5600250			250	385													4,92
STL5600300		300	435	5,56													
STL5600400		400	535	6,82													
STL5600500		500	635	8,08													
STL5600600		600	735	9,35													
STL5600800		800	835	11,88													
STL5601000		1000	1135	14,41													
STL5601500		1500	1635	20,77													
STL3500100300		90	300	440							105	1/2"	50	M95x2	34	90,6	7,79
STL0901050400	400		540	9,58													
STL0901050500	500		640	11,37													
STL0901050600	600		740	13,16													
STL0901050800	800		840	16,74													
STL0901051000	1000		1140														

GEDREHTES ZYLINDERROHR MIT ANGESCHWEISSTEM ANSCHLUSSGEWINDE I
TURNED CYLINDER TUBE WITH WELDED THREADED PORT

STL | M250

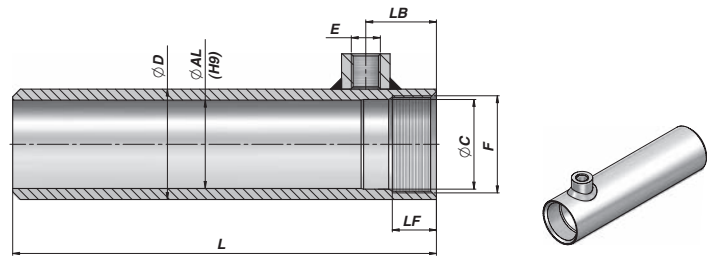

Code Bestell-Nr.	ØAL	Stroke Hub	L	ØD	E BSP	LB	F	LF	ØC	kg
STL67700200	100	200	360	115	1/2"	70	M105x2	52	100,6	7,17
STL67700250		250	410							8,16
STL67700300		300	460							9,14
STL67700400		400	560							11,12
STL67700500		500	660							13,09
STL67700600		600	760							15,07
STL67700800		800	960							19,02
STL67701000		1000	1160							22,97
STL67701500		1500	1660							32,89

MATERIAL:
 STEEL - STAHL St 52.3 DIN 2393 ISO H9

STS | M250

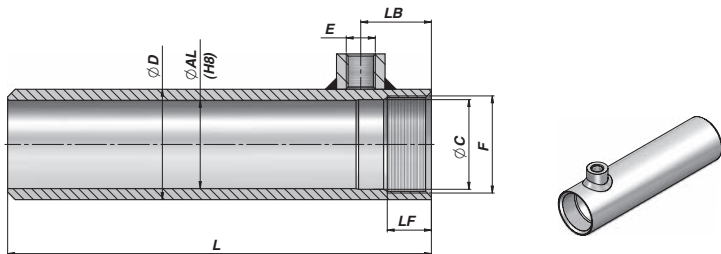

Code Bestell-Nr.	ØAL	Stroke Hub	L	ØD	E BSP	LB	F	LF	ØC	kg							
STS5700200	80	200	335	95	1/2"	50	M85x2	34	80,6	5,44							
STS5700250		250	385							6,25							
STS5700300		300	435							7,05							
STS5700400		400	535							8,66							
STS5700500		500	635							10,27							
STS5700600		600	735							11,87							
STS5700800		800	935							15,09							
STS5701000		1000	1135							18,31							
STS6700200		100	200							360	115	1/2"	70	M105x2	52	100,6	7,17
STS6700250			250							410							8,16
STS6700300	300		460	7,14													
STS6700400	400		560	11,12													
STS6700500	500		660	13,09													
STS6700600	600		760	15,07													
STS6700800	800		960	19,02													
STS6701000	1000		1160	22,97													

MATERIAL:
 STEEL - STAHL St 52.3 DIN 2391 ISO H8

GEDREHTES ZYLINDERROHR MIT ANGESCHWEISSTEM ANSCHLUSSGEWINDE UND FLANSCH I
TURNED CYLINDER TUBE WITH WELDED THREADED PORT AND FLANGE

STFG | M250

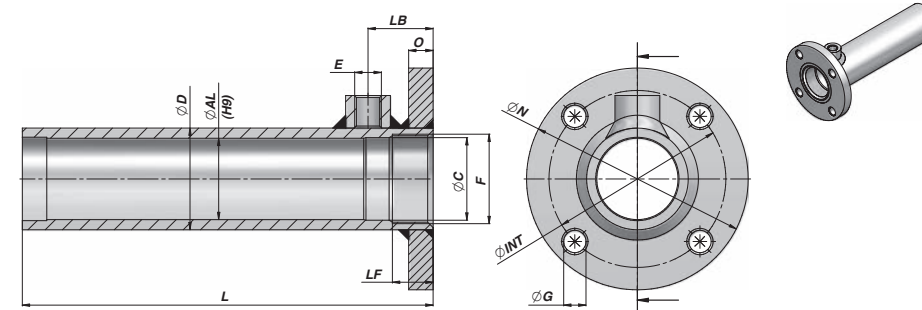

Code Bestell-Nr.	ØAL	Stroke Hub	L	ØD	E BSP	LB	F	LF	ØC	Flange - Flansch				kg
										ØN	ØO	ØG	ØINT	
STFG040050100	40	100	202	50	1/4"	32	M44x1,5	20	40,6	109	12,5	Ø11x4	87	1,80
STFG040050200		200	302											2,30
STFG040050300		300	402											2,80
STFG040050400		400	502											3,40
STFG040050500		500	602											3,90
MACHINED FOR INTERNAL END-PLUG/FÜR INNENBODEN GEEIGNET: CODE CFI0410012														
STFG050050100	50	100	212	60	3/8"	35	M45x1,5	23	50,6	128	14,5	Ø13x4	105	2,50
STFG050050200		200	312											3,20
STFG050050300		300	412											3,80
STFG050050400		400	512											4,50
STFG050050500		500	612											5,20
MACHINED FOR INTERNAL END-PLUG/FÜR INNENBODEN GEEIGNET: CODE CFI0510012														
STFG060050100	60	100	230	70	3/8"	40	M64x1,5	28	60,6	142	16,5	Ø13x4	117	3,20
STFG060050200		200	330											4,00
STFG060050300		300	430											4,80
STFG060050400		400	530											5,60
STFG060050500		500	630											6,40
MACHINED FOR INTERNAL END-PLUG/FÜR INNENBODEN GEEIGNET: CODE CFI0610015														
STFG070050100	70	100	230	80	3/8"	40	M74x1,5	28	70,6	162	16,5	Ø15x4	127	3,90
STFG070050200		200	330											4,80
STFG070050300		300	430											5,80
STFG070050400		400	530											6,70
STFG070050500		500	630											7,60
MACHINED FOR INTERNAL END-PLUG/FÜR INNENBODEN GEEIGNET: CODE CFI0710015														
STFG080070100	80	100	250	95	1/2"	50	M85x2	34	80,6	181	18,5	Ø17x6	149	6,30
STFG080070200		200	350											7,90
STFG080070300		300	450											9,50
STFG080070400		400	550											11,20
STFG080070500		500	650											12,70
MACHINED FOR INTERNAL END-PLUG/FÜR INNENBODEN GEEIGNET: CODE CFI0810017														
STFG100070100	100	100	278	115	1/2"	70	M105x2	52	100,6	194	24,5	Ø17x6	162	8,50
STFG100070200		200	378											10,50
STFG100070300		300	478											12,50
STFG100070400		400	578											14,50
STFG100070500		500	678											16,50
MACHINED FOR INTERNAL END-PLUG/FÜR INNENBODEN GEEIGNET: CODE CFI0810017														

MATERIAL:
 TUBE - ROHR: St 52.3 DIN 2393 ISO H9 - FLANGE - FLANSCH: S355J0 (Fe510C)

SBL | M250

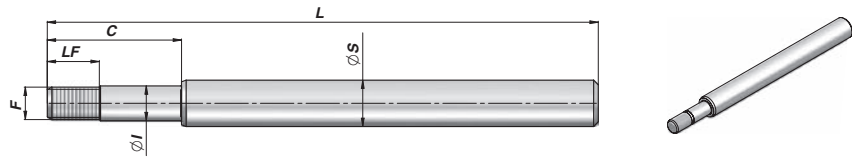

Code Bestell-Nr.	ØAL	Bore Kolben-Ø	Stroke Hub	L	Ø1	C	F	LF	kg
SBL0160250050	16	25	50	128	11	31	M10x1,5	24,5	0,18
SBL0160250100			100	178					0,25
SBL0160250150			150	228					0,33
SBL0160250200			200	278					0,40
SBL0200320050	20	32	50	147	15	48	M14x1,5	21	0,30
SBL0200320100			100	197					0,43
SBL0200320150			150	247					0,55
SBL0200320200			200	297					0,67
SBL0200320250			250	347					0,79
SBL0200320300			300	397					0,91
SBL0200320400			400	497					1,10
SBL0200320500			500	597					1,40
SBL2010100	20	40	100	220	15	58	M14x1,5	23	0,48
SBL2010150			150	270					0,60
SBL2010200			200	320					0,72
SBL2010250			250	370					0,84
SBL2010300			300	420					0,97
SBL2010350			350	470					1,09
SBL2010400			400	520					1,21
SBL2010450			450	570					1,33
SBL2010500			500	620					1,46
SBL2510100			25	40					100
SBL2510150	150	270			0,89				
SBL2510200	200	320			1,08				
SBL2510250	250	370			1,27				
SBL2510300	300	420			1,47				
SBL2510350	350	470			1,66				
SBL2510400	400	520			1,85				
SBL2510450	450	570			2,04				
SBL2510500	500	620			2,23				
SBL2510550	550	670			2,42				
SBL2510600	600	720			2,61				
SBL2520100	25	50			100	230	20	65	M20x1,5
SBL2520150			150	280	0,98				
SBL2520200			200	330	1,17				
SBL2520250			250	380	1,37				
SBL2520300			300	430	1,56				
SBL2520350			350	480	1,75				
SBL2520400			400	530	1,94				
SBL2520450			450	580	2,13				
SBL2520500			500	630	2,32				
SBL2520550			550	680	2,51				
SBL2520600			600	730	2,71				
SBL2520800			800	930	3,47				
SBL2521000			1000	1130	4,24				

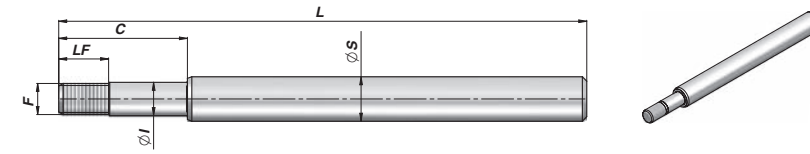

Code Bestell-Nr.	ØAL	Bore Kolben-Ø	Stroke Hub	L	Ø1	C	F	LF	kg
SBL3020100	30	50	100	230	20	65	M20x1,5	30	0,90
SBL3020150			150	280					1,12
SBL3020200			200	330					1,34
SBL3020250			250	380					1,57
SBL3020300			300	430					1,79
SBL3020350			350	480					2,01
SBL3020400			400	530					2,24
SBL3020450			450	580					2,46
SBL3020500			500	630					2,68
SBL3020550			550	680					2,91
SBL3020600			600	730					3,13
SBL3020700			700	830					3,58
SBL3020800	800	930	4,02						
SBL3021000	1000	1130	4,92						
SBL3021500	1500	1630	7,17						
SBL3030100	30	60/70	100	248	20	75	M20x1,5	30	1,14
SBL3030150			150	298					1,41
SBL3030200			200	348					1,69
SBL3030250			250	398					1,97
SBL3030300			300	448					2,24
SBL3030350			350	498					2,52
SBL3030400			400	548					2,79
SBL3030450			450	598					3,07
SBL3030500			500	648					3,34
SBL3030550			550	698					3,62
SBL3030600			600	748					3,89
SBL3030800			800	948					5,00
SBL3031000	1000	1148	6,10						
SBL3530100	35	60/70	100	248	20	75	M20x1,5	30	1,48
SBL3530150			150	298					1,86
SBL3530200			200	348					2,23
SBL3530250			250	398					2,61
SBL3530300			300	448					2,98
SBL3530350			350	498					3,36
SBL3530400			400	548					3,73
SBL3530450			450	598					4,11
SBL3530500			500	648					4,48
SBL3530550			550	698					4,86
SBL3530600			600	748					5,23
SBL3530800			800	948					6,74
SBL3531000	1000	1148	8,24						
SBL3531500	1500	1648	11,99						
SBL4040200	40	60/70	200	348	27	75	M27x2	30	3,01
SBL4040250			250	398					3,50
SBL4040300			300	448					3,99
SBL4040350			350	498					4,48
SBL4040400			400	548					4,97
SBL4040450			450	598					5,46
SBL4040500			500	648					5,95
SBL4040550			550	698					6,44
SBL4040600			600	748					6,93
SBL4040800			800	948					8,89
SBL4041000			1000	1148					10,85
SBL4041500			1500	1648					15,58

SBL | M250

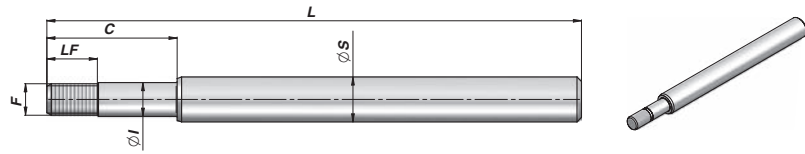

Code Bestell-Nr.	ØAL	Bore Kolben-Ø	Stroke Hub	L	Ø1	C	F	LF	kg						
SBL0400630200	40	63	200	348	24	75	M24x2	35	2,92						
SBL0400630250			250	398					3,40						
SBL0400630300			300	448					3,90						
SBL0400630400			400	548					4,88						
SBL0400630500			500	648					5,87						
SBL0400630600			600	748					6,85						
SBL0400630800			800	948					8,80						
SBL0400631000			1000	1148					10,76						
SBL4050200			40	80					200	368	27	83	M27x2	38	3,17
SBL4050250									250	418					3,66
SBL4050300	300	468			4,15										
SBL4050400	400	568			5,13										
SBL4050500	500	668			6,11										
SBL4050600	600	768			7,09										
SBL4050800	800	968			9,05										
SBL4051000	1000	1168			11,01										
SBL5050200	50	80			200	368	27	83	M27x2	38					4,74
SBL5050250					250	418									5,50
SBL5050300			300	468	6,27										
SBL5050400			400	568	7,80										
SBL5050500			500	668	9,33										
SBL5050600			600	768	10,86										
SBL5050800			800	968	13,93										
SBL5051000			1000	1168	16,99										
SBL5051500			1500	1668	24,64										
SBL0500900300			50	90	300	471					33	88	M33x2	43	6,46
SBL0500900400	400	571			8,00										
SBL0500900500	500	671			9,54										
SBL0500900600	600	771			11,09										
SBL0500900800	800	971			14,17										
SBL0500901000	1000	1171			17,25										
SBL5060200	50	100			200	395	33	88	M33x2	43					5,29
SBL5060250					250	445									6,06
SBL5060300					300	495									6,82
SBL5060400					400	595									8,35
SBL5060500			500	695	9,89										
SBL5060600			600	795	11,42										
SBL5060800			800	995	14,48										
SBL5061000			1000	1195	17,54										
SBL6060300			60	100	300	495					33	88	M33x2	43	9,56
SBL6060400					400	595									11,77
SBL6060500	500	695			13,98										
SBL6060600	600	795			16,18										
SBL6060800	800	995			20,59										
SBL6061000	1000	1195			25,00										
SBL6061500	1500	1695			36,00										

SBFG | M250

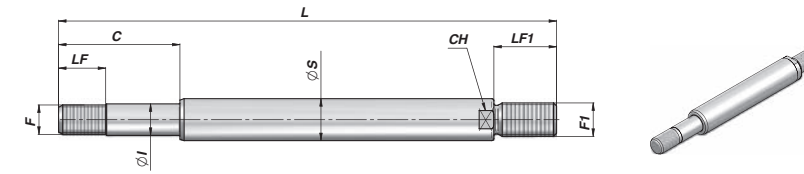

Code Bestell-Nr.	ØS	Bore Kolben-Ø	Stroke Hub	L	Ø1	C	F	LF	F1	LF1	CH	kg
SBFG200400100	20	40	100	238	15	58	M14x1,5	23	M16x1,5	30	18	0,60
SBFG200400200			200	338								0,74
SBFG200400300			300	438								0,98
SBFG200400400			400	538								1,23
SBFG200400500			500	638								1,47
SBFG300500100	30	50	100	258	20	65	M20x1,5	35	M20x1,5	40	26	1,10
SBFG300500200			200	38								1,65
SBFG300500300			300	458								2,20
SBFG300500400	400	558	2,75									
SBFG300500500	500	658	3,30									
SBFG350600100	35	60	100	285	24	75	M24x2	35	M27x2	50	32	1,68
SBFG350600200			200	385								2,43
SBFG350600300			300	485								3,18
SBFG350600400			400	585								3,95
SBFG350600500			500	685								4,68
SBFG400700100	40	70	100	397	27	75	M27x2	30	M30x2	60	36	2,26
SBFG400700200			200	397								3,25
SBFG400700300			300	497								4,26
SBFG400700400			400	597								5,25
SBFG400700500			500	697								6,25
SBFG500800100	50	80	100	328	27	83	M27x2	38	M36x2	70	45	3,51
SBFG500800200			200	428								5,12
SBFG500800300			300	528								6,65
SBFG500800400			400	628								8,18
SBFG500800500			500	728								9,71
SBFG501000100	50	1000	100	355	33	88	M33x2	43	M36x2	70	45	4,18
SBFG501000200			200	455								5,70
SBFG501000300			300	555								7,25
SBFG501000400			400	655								8,79
SBFG501000500			500	755								10,33